

kreon installation manual

technics & dimensions

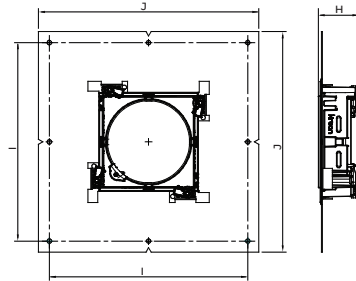

name	reference	J	I	H
Concrete plasterkit down in-line 80	KR717119	430	410	37
Concrete plasterkit down in-line 80 shadow gap	KR717111	430	410	37
Concrete plasterkit down in-line 80 small	KR717412	200	180	37
Concrete plasterkit down in-line 80 small shadow gap	KR717417	200	180	37
Concrete plasterkit down in-line 165	KR717219	270	246	73
Concrete plasterkit down in-line 165 shadow gap	KR717211	270	246	73
Concrete plasterkit down in-line 40	KR707111	150	130	24
Concrete plasterkit down in-line 40 deep recessed	KR707711	150	130	51

technics & dimensions

In case of precast concrete panels,
gear inclusive

In case of finished concrete ceiling,
gear exclusive

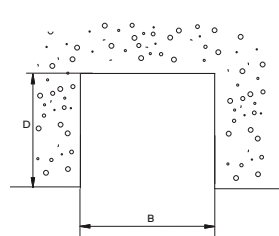
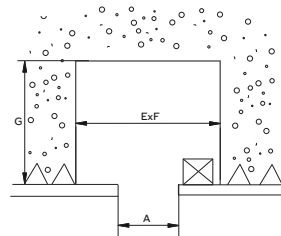

name	lamp type	ØA	G	ExF	□orØB	D
Concrete plasterkit down in-line 80	QR-CBC51	140	200	320x320	170	130
	LED dir.	140	120	344x344	390	120
	fixed, WW	140	100	260x260	250	100
	audio	140	130	200x200	150	130
Concrete plasterkit down in-line 165	LED	Ø252 or □200	230	350x350	210	230
Concrete plasterkit down in-line 40	fixed, WW, dir	110	80	110x110	110	80
Concrete plasterkit down in-line 40 deep recessed	fixed	110	104	110x110	110	104

installation

Put the plasterkit through the hole

Fix the plasterkit with screws

Align the box with the plasterboard using the thumb screw.
Fix these screws with a hexagon screw key.

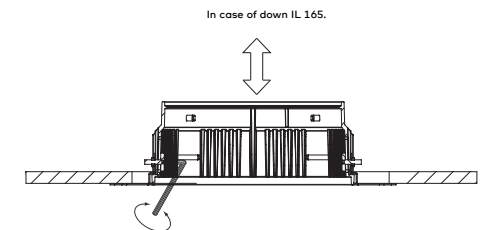
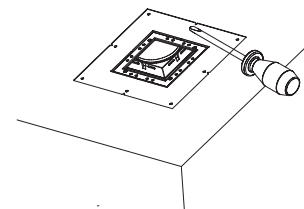
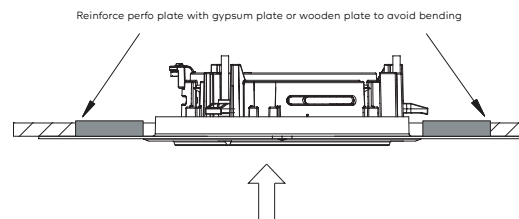

kreon installation manual

installation

In case of 80 range
please make sure that
sticker is removed
before proceeding

Fill around perimeter of plasterkit using suitable filler
and plaster to hide screws and plasterkit.

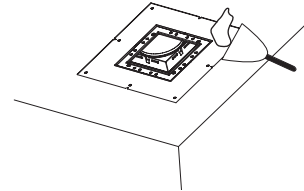

Minimum filler distance, spread out until zero.

