

Date: \_\_\_\_\_ Customer: \_\_\_\_\_

Project: \_\_\_\_\_

Type: \_\_\_\_\_ Qty: \_\_\_\_\_



Cana, creating rhythms and patterns.

kreon cana is a minimal architectural lighting channel that can be equipped with a wide range of LED luminaires. When recessed, kreon cana in white gives depth to ceiling planes whilst kreon cana in black provides a visible separation or an impression of a void beyond. When surface or pendant mounted, kreon cana provides an architectural beam for lighting integration.



kreon cana 80 is offered in three widths and can accommodate kreon holon circular, kreon prologe square semi-recessed spotlights, kreon holon surface spotlights, and kreon ligna continuous lines of light. The wide choice of luminaires can be mixed and arranged to suit the various demands and present illumination where it is required.

Any combination of light modules can be specified in a made to measure channel creating a unique installation for every project. Channel runs are delivered pre-assembled for ease of installation on site guaranteeing the finished product is exactly as designed.

**Cana 80 Tools of Light (other options available. See Ordering Options section for full range)**

## Construction

**Linear Profile & Cover Plate** – Made from extruded aluminum

**Cana 80 Luminaires** – Made from die cast aluminum alloy. Integrated optic

**Finishes for Cana 80 Linear Profile**

Matte black or white powder coated vertical run with matte black or white cover plate.

**Finishes for Cana 80 Linear Channel and Luminaires**

- White (RAL 9016)
- Black (RAL 9004)
- RAL color finish on request

**Mounting Options**

Recessed, surface, or pendant mounted



**Holon 80 Single and Holon 80 Directional in-Cana recessed**

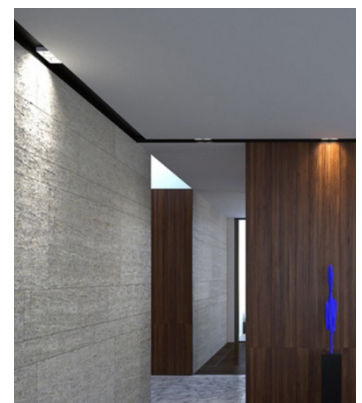

**Prologe 80 twin in-Cana recessed**

## Electrical Characteristics

**LED Specification**  
**Cana 80 Luminaires** — Xicato Zhaga compliant LED module with Corrected Cold Phosphor Technology® and remote phosphor to limit color shift over time. Tight color consistency within 1x2 MacAdam Ellipses.

**For Warm Dim and Tunable White Options**

Lumenetix Araya 5 LED module - 5 color chip array to stabilize coloring across

full spectrum, with all 1640-8000K whites occurring fully on black body curve, maintaining 95CRI or better. Tight color consistency with Max 2 SSD.

**LED Life** – L80 greater than 50,000 hours.

**Correlated Color Temperature (CCT)**

Available in 2700K, 3000K, 3500K and 4000K, Warm Dim range 1800K-3000K, tunable white range 1650K-8000K.

CRI 85+, 95+, 98+

**Gear**

Standard 0-10V dimming, universal voltage (120-277V), or TRIAC phase dimming (120V only). For non-dimming applications, cap off dimming wires. Additional dimming options available. See ordering codes for full list of options. Some lighting elements require different circuits.

## Ordering Codes and Options

The Cana 80 linear system offers the designer incredible flexibility to combine single, double, round, square, or mono-point luminaires in virtually any configuration imaginable within an architecturally detailed recessed channel system. Cana systems are made to order for each project. To customize each run, please use the configuration sequence below. Configurations can be remodeled in the field without removing the recessed channel, but may require additional components from Kreon.

The Cana 80 series is made to measure and suit many architectural needs. Each run will consist of a linear aluminum profile/channel, and different types of lighting elements. To place an order, please follow these steps to specify each unique run or type. First choose the channel details (length, finish color, mounting condition, etc), then select details for each lighting element you want to specify. Transfer individual codes to section at bottom for final specification. Lighting configuration determined via shop drawings.

## Cana 80 Channel Options

Combine with ordering codes for lighting elements on pages 3-4. Write down your choices on the grey boxes.

| KUCANA -                 | 80 -                                 | ___ -  | ___ -   | ___ -  | ___ -                                  | ___ -  | ___ -   | ___ -  | ___ -  |
|--------------------------|--------------------------------------|--|---|--|--|--|---|--|--|
| KREON CANA LINEAR SYSTEM | APERTURE SIZE                        | CHANNEL LENGTH (IN)  | CHANNEL FINISH*   | CHANNEL FACEPLATE FINISH   | FIXTURE FINISH                         | MOUNTING OPTION  | CEILING TYPE  | DIMMING  | NUMBER OF CIRCUITS                               |
|                          | 80 mm (internal) ~4" outer dimension | Channel length in inches. Use three numbers, for example, 92 inches would be 092. (Consult factory for increments smaller than 1") | <b>1</b> – White<br><b>2</b> – Black<br><b>3</b> – Clear Anodized Aluminum<br><br>Finish color for vertical panels and exterior (if visible). | <b>IC1</b> – White<br><b>IC2</b> – Black<br><b>IC3</b> – Clear Anodized Aluminum | <b>F1</b> – White<br><b>F2</b> – Black | <b>RN</b> – Recessed, no flange<br><b>SF</b> – Surface Mounted | <b>DW</b> – Drywall/ sheetrock (trimless installation)<br><b>GR</b> – ACT panels with grid ceiling<br><b>OT</b> – Other, please consult factory | <b>D1</b> – Triac Phase Dim (120V only)<br><b>D2</b> – 0-10V dim (10%) (120V – 277V)<br><b>D2LD</b> – 0-10V dim (1%) (120-277V)<br><b>D3</b> – Lutron Hi-Lume 1% dim (consult factory for 2-wire, 3-wire, or digital control)<br><b>D4</b> – EldoLED 0% Dim to Dark (multiple circuits per run possible) | Number of circuits or switch groups for this run |
| KUCANA -                 | 80 -                                 | ___ -  | ___ -   | ___ -  | ___ -                                  | ___ -  | ___ -   | ___ -  | ___ -  |

\*Consult factory for custom RAL finish color options.

System available with 90 degree or custom corner segments. Consult factory for details and configuration





Cana luminaires lend support for LEED credits and certification.

## Lighting Element Ordering Codes

Combine with ordering codes for linear segments on page 2. Write down your choices on the grey boxes.

|  <b>Prologe 80 Single in-Cana**</b>   | FINISH COLOR  | CCT  | CRI (MIN)                              | BEAM ANGLE                                      | QUANTITY PER RUN                                | ACCESSORIES   |
|--|---|--|--|---|---|---|
|  | <b>WHT</b><br><b>BLK</b><br><br><b>WD</b> warm dim<br><b>TW</b> tunable white | 27 2700K<br>30 3000K<br>35 3500K<br>40 4000K | <b>85</b><br><b>95 **</b><br><b>98</b> | <b>SP 16°</b><br><b>NR 28°</b><br><b>FL 36°</b> | (Write down desired number of fixtures per run) | <b>AG</b> Hexagonal<br><b>AGL</b> Anti-Glare Louver<br><b>DL</b> Diffusing Lens |
| <b>KUCANA-80-PRO1</b>  |   |  |  |   |   |   |
| Electrical Data: 965 lm @ 1x 11W (700 lm @ 11W for 98+ CRI) Minimum Spacing*: 6.5" on center<br>Rotation/inclination: 360°/30° • Size: 3 1/3" x 3 1/3" • ** 95 CRI for WD, TW, options only. |   |  |  |   |   |   |

|  <b>Prologe 80 Twin in-Cana**</b>  | FINISH COLOR  | CCT  | CRI (MIN)                              | BEAM ANGLE                                      | QUANTITY PER RUN                                | ACCESSORIES   |
|---|---|--|--|---|---|---|
|   | <b>WHT</b><br><b>BLK</b><br><br><b>WD</b> warm dim<br><b>TW</b> tunable white | 27 2700K<br>30 3000K<br>35 3500K<br>40 4000K | <b>85</b><br><b>95 **</b><br><b>98</b> | <b>SP 16°</b><br><b>NR 28°</b><br><b>FL 36°</b> | (Write down desired number of fixtures per run) | <b>AG</b> Hexagonal<br><b>AGL</b> Anti-Glare Louver<br><b>DL</b> Diffusing Lens |
| <b>KUCANA-80-PROT</b>   |   |  |  |   |   |   |
| Electrical Data: 2x 965 lm @ 2x 11W (2x 700 lm @ 2x 11W for 98+ CRI) • Minimum Spacing*: 8" on center<br>Rotation/inclination: 360°/30° • Size: 3 1/3" x 7 1/2" • ** 95 CRI for WD, TW, options only. |   |  |  |   |   |   |

|  <b>Holon 80 Single in-Cana**</b>  | FINISH COLOR  | CCT  | CRI (MIN)                              | BEAM ANGLE                                      | QUANTITY PER RUN                                | ACCESSORIES   |
|---|---|--|--|---|---|---|
|   | <b>WHT</b><br><b>BLK</b><br><br><b>WD</b> warm dim<br><b>TW</b> tunable white | 27 2700K<br>30 3000K<br>35 3500K<br>40 4000K | <b>85</b><br><b>95 **</b><br><b>98</b> | <b>SP 16°</b><br><b>NR 28°</b><br><b>FL 36°</b> | (Write down desired number of fixtures per run) | <b>AG</b> Hexagonal<br><b>AGL</b> Anti-Glare Louver<br><b>DL</b> Diffusing Lens |
| <b>KUCANA-80-HOL1</b>   |   |  |  |   |   |   |
| Electrical Data: 965 lm @ 11W (700 lm @ 11W for 98+ CRI) • Minimum Spacing*: 6.5" on center<br>Rotation/inclination: 360°/30° • Size: 3 1/3" diameter • ** 95 CRI for WD, TW, options only. |   |  |  |   |   |   |

|  <b>Holon 80 Twin in-Cana**</b>   | FINISH COLOR  | CCT  | CRI (MIN)                              | BEAM ANGLE                                      | QUANTITY PER RUN                                | ACCESSORIES   |
|--|---|--|--|---|---|---|
|  | <b>WHT</b><br><b>BLK</b><br><br><b>WD</b> warm dim<br><b>TW</b> tunable white | 27 2700K<br>30 3000K<br>35 3500K<br>40 4000K | <b>85</b><br><b>95 **</b><br><b>98</b> | <b>SP 16°</b><br><b>NR 28°</b><br><b>FL 36°</b> | (Write down desired number of fixtures per run) | <b>AG</b> Hexagonal<br><b>AGL</b> Anti-Glare Louver<br><b>DL</b> Diffusing Lens |
| <b>KUCANA-80-HOLT</b>  |   |  |  |   |   |   |
| Electrical Data: 2x 965 lm @ 2x 11W (700 lm @ 2x 11W for 98+ CRI) • Minimum Spacing*: 13" on center<br>Rotation/inclination: 360°/30° • Size: 3 1/3" x 7 1/2" diameter • ** 95 CRI for WD, TW, options only. |   |  |  |   |   |   |

## Lighting Element Ordering Codes

Combine with ordering codes for linear segments on page 2. Write down your choices on the grey boxes.

| Holon 80 Directional in-Cana**  | FINISH COLOR            | CCT             | CRI (MIN)     | BEAM ANGLE                  | LUMEN SOURCE               | QUANTITY PER RUN                                | ACCESSORIES         |
|---|-------------------------|-----------------|---------------|-----------------------------|----------------------------|---|---------------------|
|   | <b>WHT</b>              | <b>27</b> 2700K | <b>85</b>     | <b>SP 16°</b>               | <b>SO</b> 1300/965lm (15W) | (Write down desired number of fixtures per run) | <b>AG</b> Hexagonal |
| <b>BLK</b>  | <b>30</b> 3000K         | <b>95**</b>     | <b>NR 28°</b> | <b>MO</b> 2000/1560lm (15W) |                            | <b>AGL</b> Anti-Glare Louver                    |                     |
|   | <b>35</b> 3500K         |                 | <b>FL 36°</b> | <b>HO</b> 3000/2200lm (30W) |                            | <b>DL</b> Diffusing Lens                        |                     |
|   | <b>40</b> 4000K         |                 |               |                             |                            | <b>SC</b> Sculptured Lens                       |                     |
|   | <b>WD</b> warm dim      |                 |               |                             |                            |   |                     |
|   | <b>TW</b> tunable white |                 |               |                             |                            |   |                     |
| <b>KUCANA-80-HOLD</b>   |                         |                 |               |                             |                            |   |                     |
| Electrical Data: 850 lm @ 9W (650 lm @ 9W for 90+ CRI) • Minimum Spacing*: 4" on center • Rotation/inclination: 355°/90° • Size: 3 1/3" dia x 8" H • ** WD, TW, options - SO and MO only. 95 CRI Max. |                         |                 |               |                             |                            |   |                     |

| Ligna 80 in-Cana  | LENGTH                  | CCT                          | CRI (MIN)             | LUMEN SOURCE                            |
|---|-------------------------|------------------------------|-----------------------|---|
|   | <b>012</b> 1 foot       | <b>27</b> 2700K <sup>1</sup> | <b>80<sup>1</sup></b> | <b>SO</b> Standard Output<br>1100lm/ft. |
| <b>024</b> 2 foot   | <b>30</b> 3000K         | <b>90</b>                    |                       |   |
| --- 1 ft  | <b>35</b> 3500K         | <b>** 95</b>                 |                       |   |
| --- 1 ft  | <b>40</b> 4000K         |                              |                       |   |
| --- 1 ft  | <b>WD</b> warm dim      |                              |                       |   |
|   | <b>TW</b> tunable white |                              |                       |   |
| <b>KUCANA-80-LIG</b>  |                         |                              |                       |   |
| Electrical Data: 1,100 lm @ 6.1W (6.1w/ft @ 80 cri, 6.1w/ft @90 cri) lengths may be requested in 5.5", 11", 24". Minimum: 11"-24" – consult factory • ** For WD, TW options : 1,000LM/FT @ 6.1W/FT for 95 CRI. Avail. in 11", 22" or 24" increments <sup>1</sup> . 2700K not available with CRI80 |                         |                              |                       |   |

## Lighting Elements Ordering Codes Summary (leave blank if not used)

|                              |                  |   |
|------------------------------|------------------|---|
| Prologe 80 Single in-Cana:   | KUCANA-80-PRO1 - | _____ - _____ - _____ - _____ - _____ - _____ |
| Prologe 80 Twin in-Cana      | KUCANA-80-PROT - | _____ - _____ - _____ - _____ - _____ - _____ |
| Holon 80 Single in-Cana      | KUCANA-80-HOL1 - | _____ - _____ - _____ - _____ - _____ - _____ |
| Holon 80 Twin in-Cana        | KUCANA-80-HOLT - | _____ - _____ - _____ - _____ - _____ - _____ |
| Holon 80 Directional in-Cana | KUCANA-80-HOLD - | _____ - _____ - _____ - _____ - _____ - _____ |
| Ligna 80 in-Cana             | KUCANA-80-LIG -  | _____ - _____ - _____ - _____ - _____ - _____ |

\* The minimum module spacing is the minimum center distance to the next in-Cana 80 module.

\*\*Holon 80 accessories: **AG** – Hexagonal Anti-Glare Louver      **SC** – Sculpture Lens      **DL** – Diffusing Lens

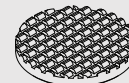
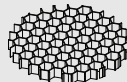

Construction



Black Prologe 80 in-Cana single in lack recessed mounted profile



White Holon 80 in-Cana single in hite recessed mounted profile

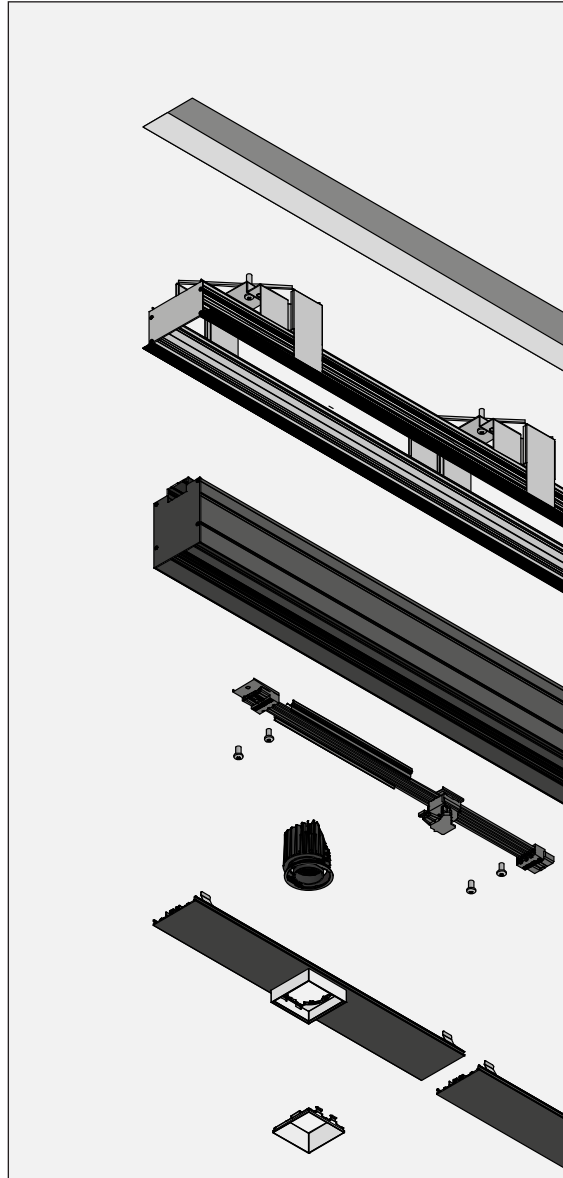

Schematic representation of assembly Prologe 80 single in-Cana: plasterkit + luminaire + louvre

cana 80 surface mounted profile

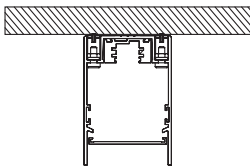

cana 80 recessed mounted profile

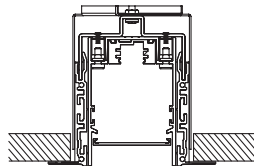

Cana Surface Mount Profile

L x W x H

L x 4" x 5 1/2"



Cana luminaires lend support for LEED credits and certification.