

technics			<table><tr><th>Name</th><th>Reference</th><th>Current</th></tr><tr><td>Holon 40 directional recessed</td><td>KR96221x</td><td>700mA</td></tr><tr><td>Holon 40 directional recessed</td><td>KR96231x-XXXX-XX</td><td>700mA</td></tr></table>						Name	Reference	Current	Holon 40 directional recessed	KR96221x	700mA	Holon 40 directional recessed	KR96231x-XXXX-XX	700mA	
Name	Reference	Current																
Holon 40 directional recessed	KR96221x	700mA																
Holon 40 directional recessed	KR96231x-XXXX-XX	700mA																
1 dimensions																		
			<table><tr><th>Name</th><th>Reference</th><th>Cut-out ØA</th><th>Visible Ø</th><th>B*</th><th>C</th></tr><tr><td>aplis in-line 40 plasterkit</td><td>KR717108</td><td>Ø 63</td><td>Ø 40</td><td>35</td><td>**</td></tr></table>	Name	Reference	Cut-out ØA	Visible Ø	B*	C	aplis in-line 40 plasterkit	KR717108	Ø 63	Ø 40	35	**	<p>* installation depth B is in case the driver is placed at a distance, so doesn't need to be pushed through the plasterkit</p> <p>** installation depth C is in case the driver has to be pushed through the plasterkit in order to be close to the fixture. Mind that the driver dimensions WxH cannot exceed 35x19mm! the length of the driver determines C as it has to be pushed perpendicular through the plasterkit. Depth = length of the driver + 30mm If the length of the driver is e.g. 150mm - C = 180mm</p>		
Name	Reference	Cut-out ØA	Visible Ø	B*	C													
aplis in-line 40 plasterkit	KR717108	Ø 63	Ø 40	35	**													
dimensions																		
			<p>first install the plasterkit KR707104 put the plasterkit through the cut-out in the ceiling</p>				<p>Please make sure that sticker is removed before proceeding!</p>		<p>fix the plasterkit with the screws</p>		<p>assembling torque max 20 CN.m.</p>							
3 installation plasterkit																		
			<p>fill around perimeter of plasterkit using suitable filler and plaster to hide screws and plasterkit.</p>					<p>minimum filler distance, spread out until zero.</p>										
installation plasterkit		assembling principle																
		<p>revision date: 28/07/2016</p> <p>KR8622102017</p>																
		<p>Sheet 1/3</p>																

technics

Please make sure that main voltage is disconnected before proceeding!

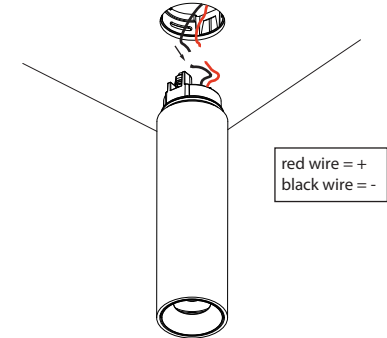
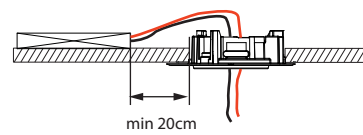
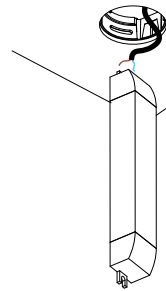

red wire = +
black wire = -

4 electric connection

in case of driver:
connect the mains supply to the driver and push the driver perpendicular through the plasterkit
(make sure the check the remark on installation depth and driver on page 1)

connect the wires coming from the gear to the wires coming from the holon. Mind the polarity of the wires!

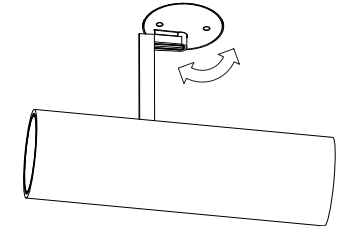
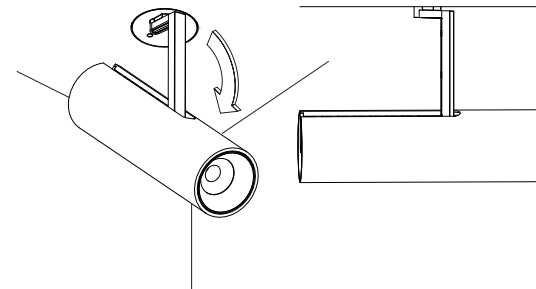
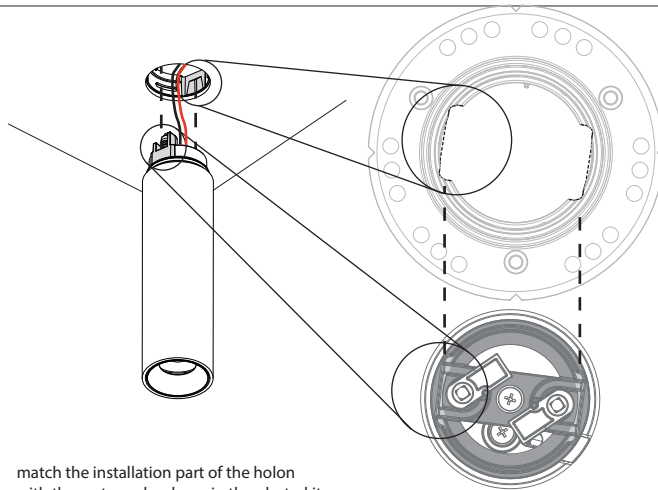

5 installation

match the installation part of the holon with the rectangular shape in the plasterkit

inclinate the tube by pulling it, to make space to reach the screwholes

rotate the fixture until the holes in the plate match the position of the screws in the installation part

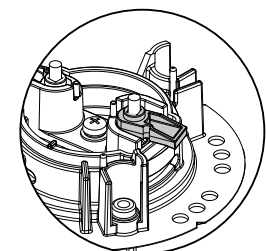
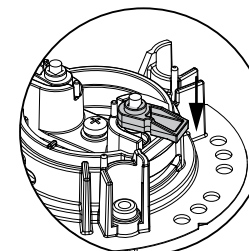
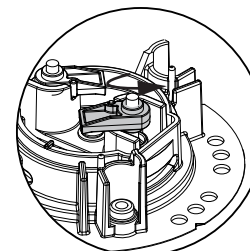
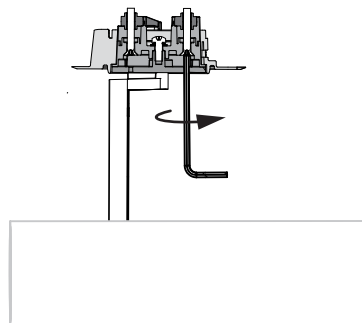
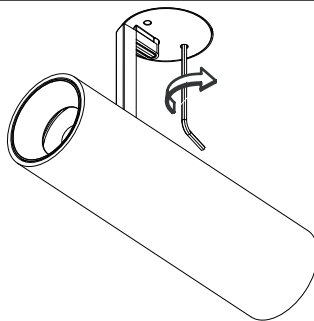

assembly principle

fix the complete fixture by turning the screws

technics

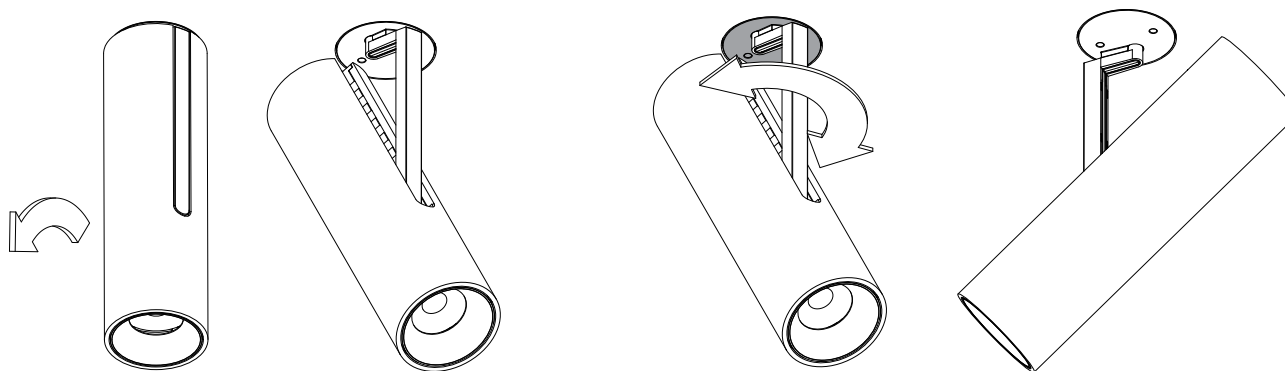

installation

once the holon is completely installed
it can be inclined in any angle up to 90° by pullin the tube

it can also be rotated for 330°

KR762000

KR762100

KR762200

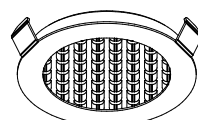
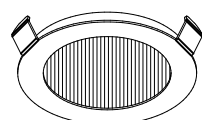
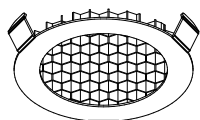

6 accessories

in case of accessories
check the manual KR8622102021 delivered with the accessory
only one accessory per holon

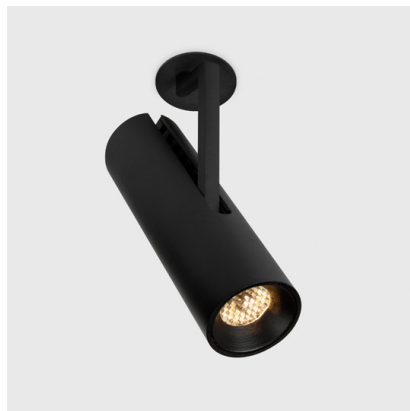
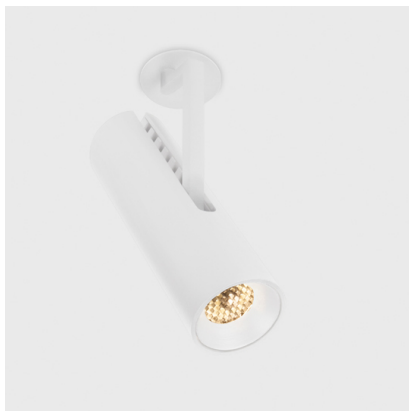

7 pictures

kreon nv

Industrieweg Noord 1152
3660 Opplabbek
Belgium

Tel + 32 89 81 97 80
Fax + 32 89 81 97 90

www.kreon.com
mailbox@kreon.be

revision date: 28/07/2016
KR8622102017

Sheet 3/3