

## technics

## Erubo

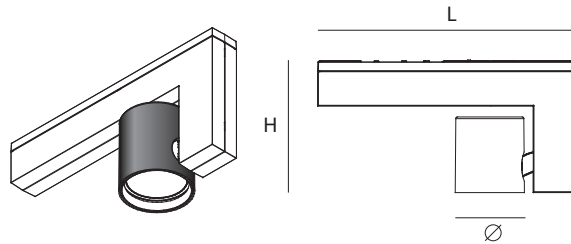

remark: due to the high temperature that occurs on the adjustable part, the luminaire must be placed out of arms reach

Name	Reference	L x H x Ø	max. W	Voltage ⚡
Erubo	kr92161x	300 x 150 x 80	60W	230V / 12 V
Erubo	kr92156x	300 x 150 x 80	20W	230 V / 1,5 V
Erubo	kr92166x	300 x 150 x 80	35W	230 V / 1,5 V
Erubo	kr92153x-C	300 x 150 x 80	17.8W	230V/1000mA
Erubo	kr92153x-X	300 x 150 x 80	11.7W	230V/700mA
Erubo	kr92163x	300 x 150 x 80	19.5W	230V/700mA
Erubo	kr92103x	300 x 150 x 80	15.6W	230V/700mA
Erubo	kr92164x - kr92165x	300 x 150 x 80	23.8W	230V/48VDC
Erubo	kr92104x - kr92105x	300 x 150 x 80	14.8W	230V/48VDC
Erubo	kr92153x-XXXX	300 x 150 x 80	19W	230V/700mA
Erubo	kr92163x-XXXX	300 x 150 x 80	19.5W	230V/700mA
Erubo	kr92164x-XXXX	300 x 150 x 80	19.6W	230V/48VDC
Erubo	kr92165x-XXXX	300 x 150 x 80	19.6W	230V/48VDC

## 1 dimensions

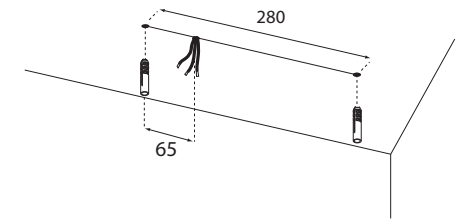
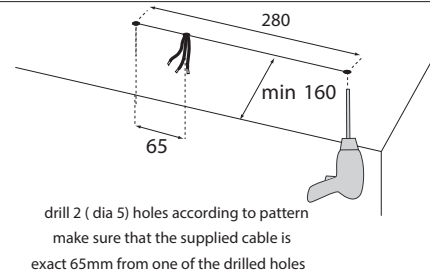
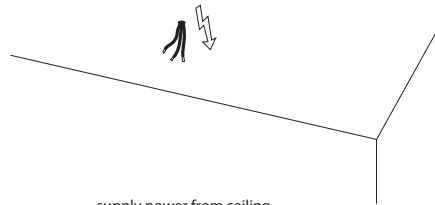

## 2 installation

supply power from ceiling

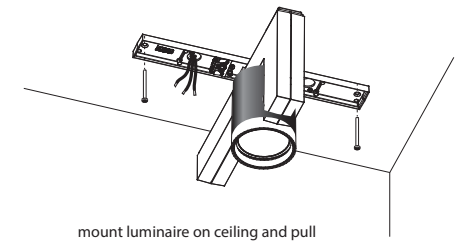
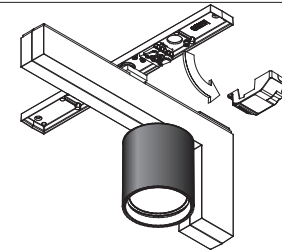
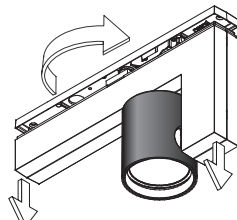

## 3 installation

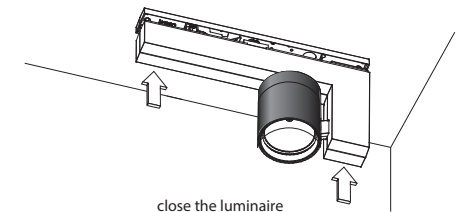
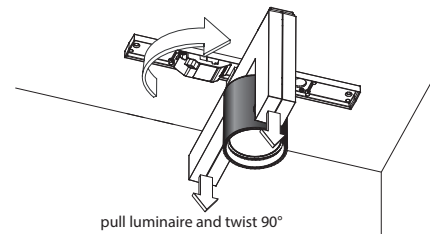
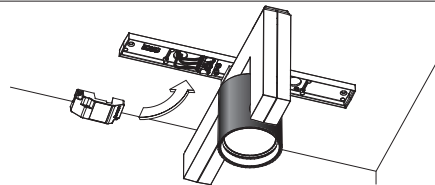

## 4 installation

## technics

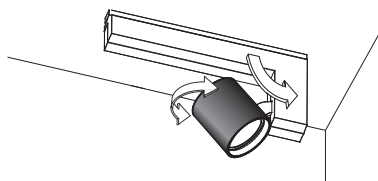

aim spotlight manually  
caution: lamp can be hot!

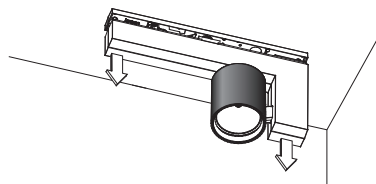

to lighten other direction  
pull luminaire on both ends

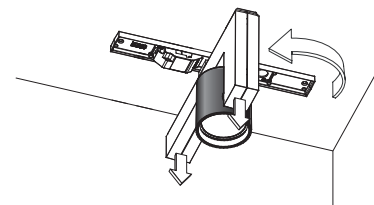

twist luminaire 180°

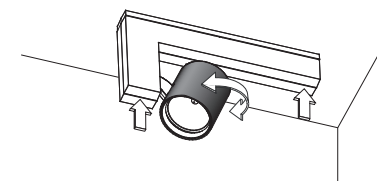

close luminaire and aim spot manually

## 5 aim spotlight

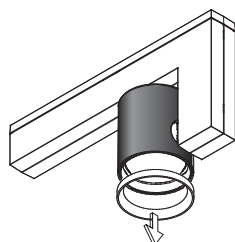

remove louvre

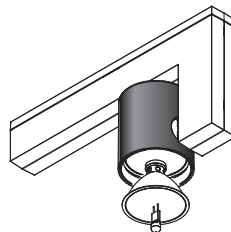

place lamp and reflector

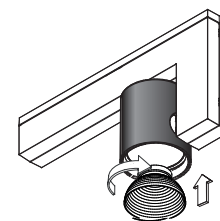

in case of the Erubo LED  
the reflector should be forced and  
twisted around the LED base

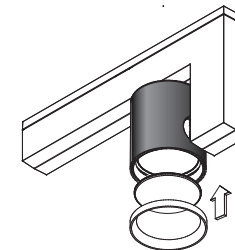

place accessory in louvre

## 6 accessories

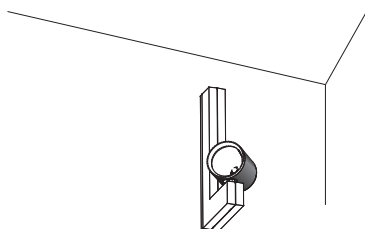

## 7 wall mounting



## 8 pictures

kreon nv

Industrieweg Noord 1152  
B 3660 Opglabbeek, Belgium

Tel + 32-89-81 97 80  
Fax + 32-89-81 97 90

www.kreon.com  
mailbox@kreon.be

Rev. date: 02/08/2017  
KR8270001656