

## technics

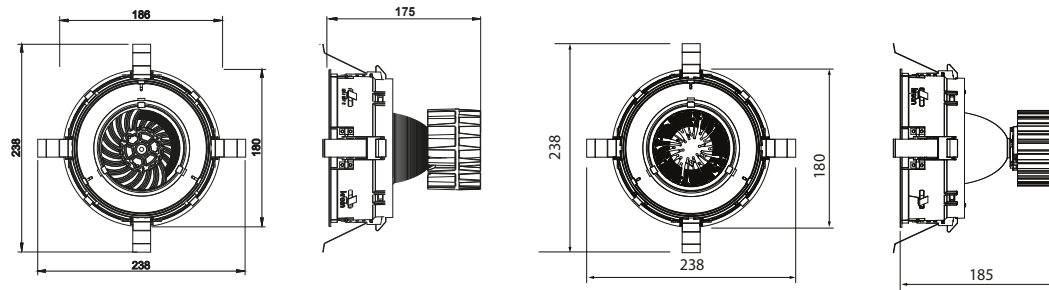

Name	Reference	current
Aplis 165 LED wallwasher	KR93743x-X-XXXX	700mA
Aplis 165 LED wallwasher 3000lm	KR93744x-XXXX	1050mA

The luminaire must not under any circumstances be covered with heat insulating covers or similar materials. Cables must not touch the luminaire housing. The connection cable must be routed so that it does not touch the lamp when the luminaire is tilted.

## 1 dimensions

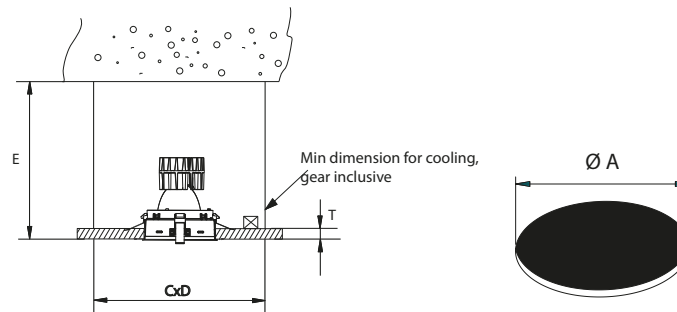

Name	Reference	ØA	CxD	E <sub>min</sub>	T <sub>min</sub> -T <sub>max</sub>
Aplis 165 LED wallwasher	KR94783x-X-XXXX	175	300x300	200	
Aplis 165 LED wallwasher 3000lm	KR93744x-XXXX	175	300x300	210	
Plasterboard thickness					9-26

## 2 cut out

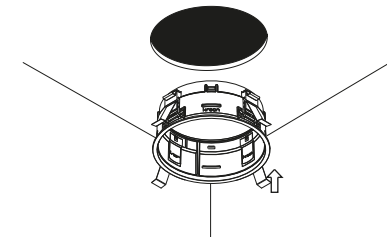
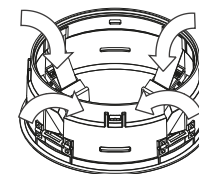
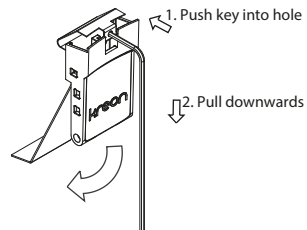
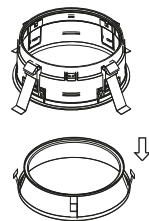

## 3 installation

Remove louvre

Open spring mechanism (4x) with an allen key.

Insert installation box in the hole.

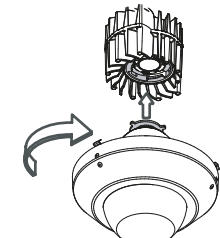
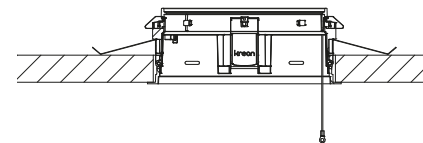
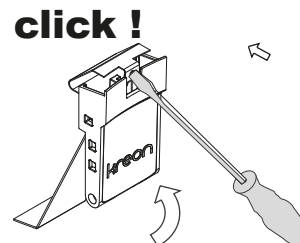
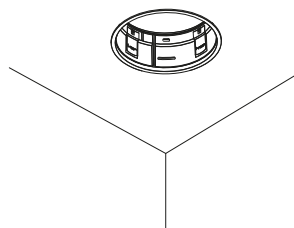

install the reflector on the LED module. the reflector is fixed by turning it on the LED, underneath the bajonet ring

## installation

Close spring mechanism (4x).

Fix the spring with a tool.

Please make sure that main voltage is disconnected before proceeding!

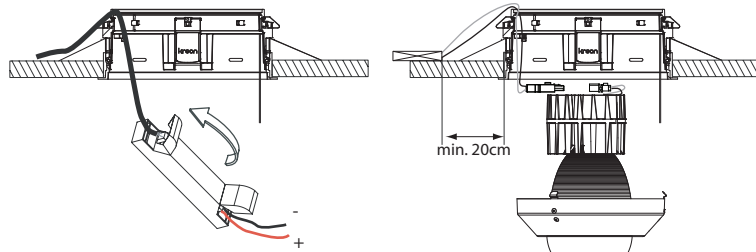

male connector is already wired as follows

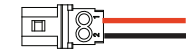

make sure the female connector is wired in the same way

2 = black  
1 = red

installation

install the correct gear with strain relief on the hollow ceiling

important: always check the polarity!!  
+ = red wire  
- = black wire

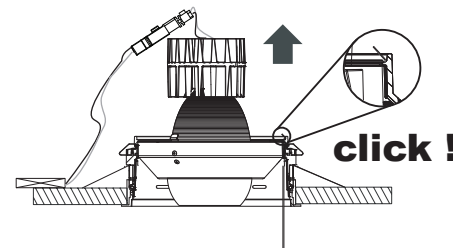
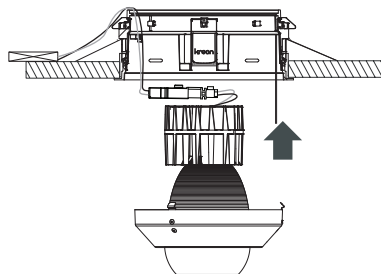

installation

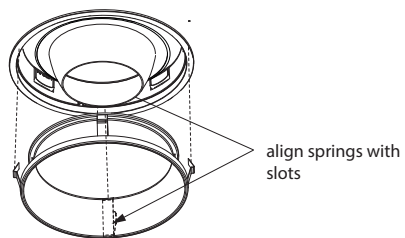

align springs with slots

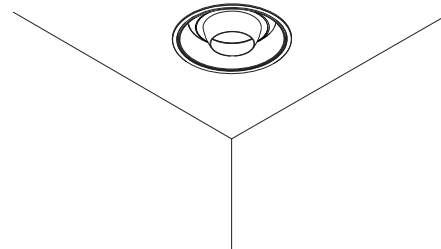

installation

Install the louvre, align the springs with the slots

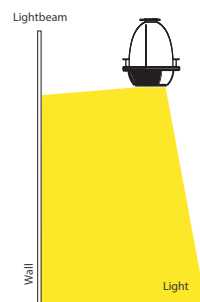

4 picture

