

kreon ato in-line

kreon ato in-line provides a truly versatile lighting tool. It is a trimless recessed indoor spotlight family for focused lighting. With single or double directional lampheads, they meet the needs of accent lighting requirements in residential environments, commercial premises and hospitality projects. kreon ato has a rotational adjustment of 360° and an angular adjustment of 30° which when combined with the choice of high quality reflectors with faceted spherical smooth surfaces provides a truly versatile accent lighting tool. kreon ato single comes in two beam angles, flood (30°) and wide flood (40°) and can be additionally equipped with professional screening accessories. kreon ato twin has two lampheads with 30° flood optics than can be tilted independently.

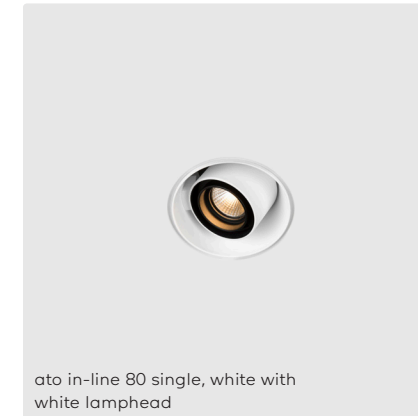

ato in-line 80 single, white with white lamphead





ato in-line 80 twin, black with black lampheads

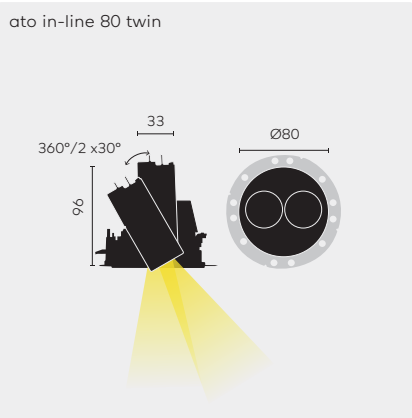
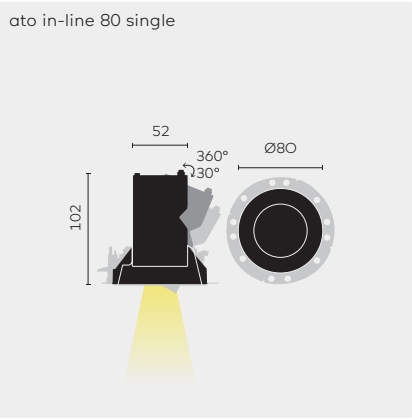

kreon ato in-line 80



	Colour louvre	KR-code	Light sources	9027 2700K, CRI90+	9030 3000K, CRI90+	FL Flood (30°)	WFL Wide flood (40°)	P1 White lamphead	P2 Black lamphead	A0 Chrome lamphead	A5 Red copper lamphead	Required accessories	Optional accessories
 ato in-line 80 single Ø 102 H min. 110	○	<u>KR917911</u>	①	●	●	●	●	●	●	●	●	■	■
	●	<u>KR917912</u>	①	●	●	●	●	●	●	●	●	■	■
 ato in-line 80 twin Ø 102 H min. 110	○	<u>KR917621</u>	②	●	●	●	●	●	●			■	■
	●	<u>KR917622</u>	②	●	●	●	●	●	●			■	■
■ Required accessories													
Plasterkit		<u>KR717104</u>	Plasterkit, no shadowgap, trimless finish										
		<u>KR717108</u>	Plasterkit, shadowgap, trimless finish										
Plasterkit concrete		<u>KR717101</u>	Plasterkit for concrete installation, no shadowgap (430x430)										
		<u>KR717102</u>	Plasterkit for concrete installation, no shadowgap, small (200x200)										
		<u>KR717109</u>	Plasterkit for concrete installation, shadowgap (430x430)										
		<u>KR717107</u>	Plasterkit for concrete installation, shadowgap, small (200x200)										
■ Optional accessories													
Glare preventer (only for ato in-line 80 single)	○	<u>KR706721</u>	Straight glare preventer, white, H30										
	●	<u>KR706722</u>	Straight glare preventer, black, H30										
	●	<u>KR706720</u>	Straight glare preventer, chrome, H30										
	●	<u>KR706725</u>	Straight glare preventer, red copper, H30										
Lenses ①		<u>KR706070</u>	Anti-glare louvre										
		<u>KR706270</u>	Diffusing lens										
Driver		<u>KR772024</u>	LED driver, 500mA, ON/OFF, 20W										
		<u>KR772220</u>	LED driver, 500mA, 1-10V, 20W										
		<u>KR772126</u>	LED driver, 500mA, DALI, 20W										
		<u>KR772542</u>	LED driver, 500mA, phase dimming, 18W										
		<u>KR772229</u>	LED driver, 500mA, Casambi, 27W										
		<u>KR772034</u>	LED driver, 700mA, ON/OFF, 20W										
		<u>KR772232</u>	LED driver, 700mA, 1-10V, 20W										
		<u>KR772236</u>	LED driver, 700mA, DALI, 18W										
		<u>KR772931</u>	LED driver, 700mA, phase dim, 14W										
		<u>KR772239</u>	LED driver, 700mA, Casambi, 36W										
	Distance rings (for plasterkit concrete)		<u>KR717307</u>	Distance ring, 2mm (set of 5pcs.)									
		<u>KR717308</u>	Distance ring, 3mm (set of 5pcs.)										
		<u>KR717309</u>	Distance ring, 5mm (set of 5pcs.)										

		CRI	CCT	Wattage	Drive current	Fixture lumen
①	LED	CRI90+	2700K/3000K	12W	700mA	1150lm
②	LED	CRI90+	2700K/3000K	2 x 5,9W	500mA	2 x 325lm

REMARKS

① Lenses only in combination with a glare preventer. Max. 2 accessories per glare preventer.

Thickness boardmaterial: 9-26mm
Gear excluded.
✦ IP20

Distance rings

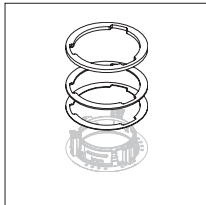

Straight glare preventer

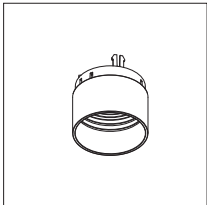

Plasterkit

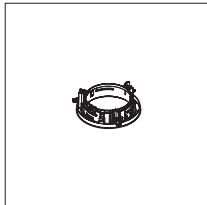

Plasterkit concrete

