

kreon installation manual

technics & dimensions

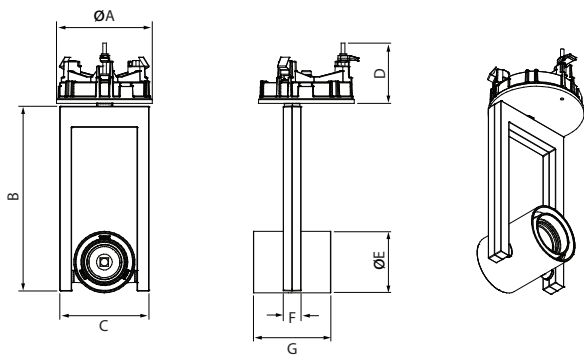

name	reference	current	ØA	B	C	D	ØE	F	G
diapason 40 base	KR90661x-xxx-xx-xx	1050mA	80.5	130	45	50.1	51	15	65
diapason 80 base	KR91661x-xxx-xx-xx	500mA	80.5	155	75	50.1	95	15	65
diapason 120 base	KR92661x-xxx-xx-xx	700mA	80.5	180	130	50.1	33	15	65

Please make sure the main voltage is disconnected before proceeding! ⚡

1. light source information

light source containing product

The light source contained in this luminaire shall only be replaced by the manufacturer or his service agent or a similar qualified person.

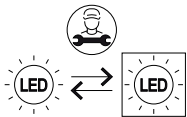

Energy Efficiency Class and EPREL-information for each specific LED/fixture can be found on the last page of this manual

2. installation

electrical diagram

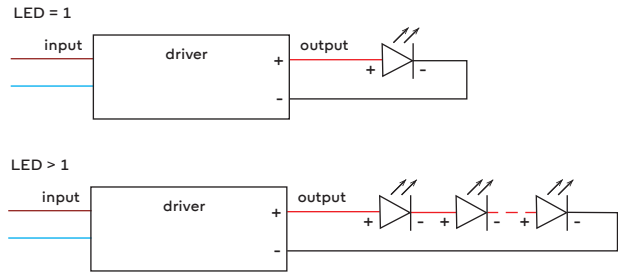

electrical diagram TW

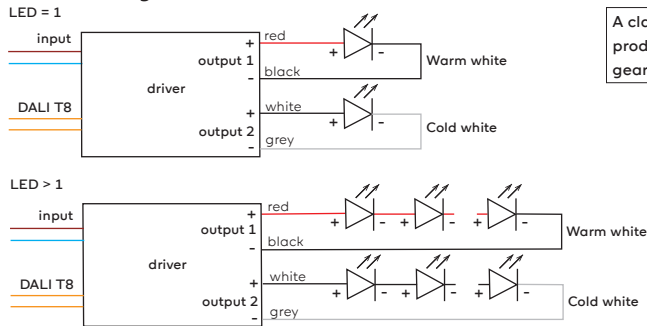

A class III-product or a string of these products in series, can only be used with a gear where $U_{out} \leq 120VDC$!

kreon installation manual

3. installation

Install installation kit of choice

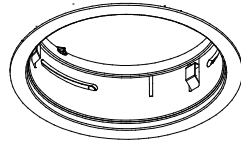

Installation kit with trim KR71702x
Consult installation manual KR8166002147

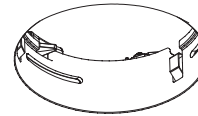

Installation kit without trim KR717104
Consult installation manual KR8170001755

4. installation

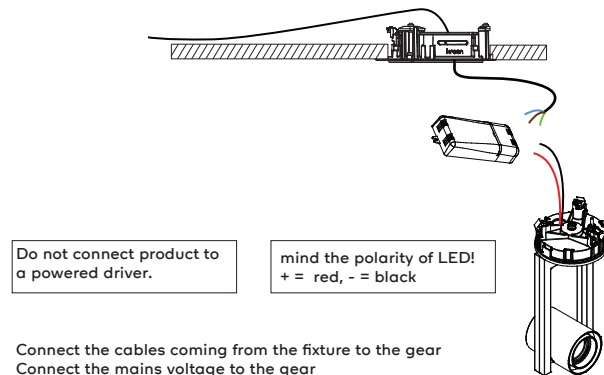

Connect the cables coming from the fixture to the gear
Connect the mains voltage to the gear

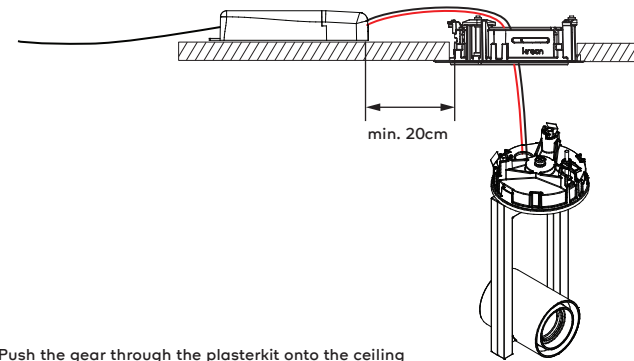

Push the gear through the plasterkit onto the ceiling

5. installation

The installation disk has two springs and one screw

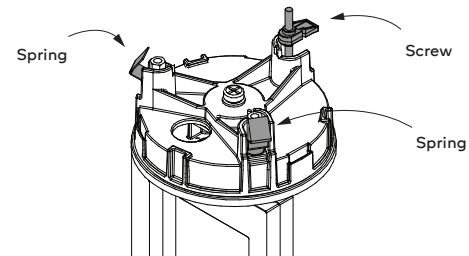

Rotate the cover disc until it's blocked and check if the hole matches the screw

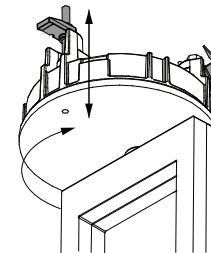

kreon installation manual

6. installation

Insert the Diapason in the installation kit

Match the details of the black plastic installation part with the springs of the installation kit

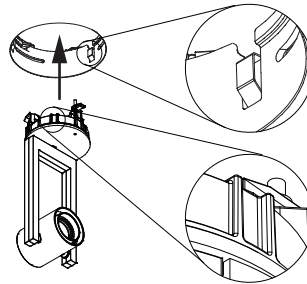

Push until the springs click over the edge of the installation kit

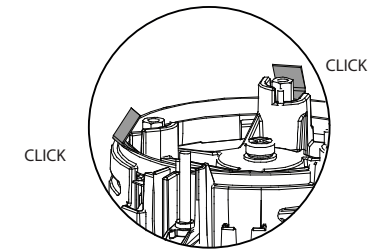

7. installation

Fix the Diapason by turning the screw with the hex key

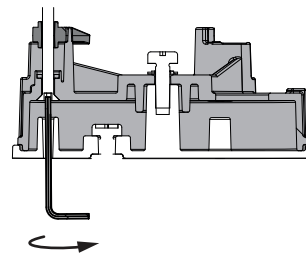
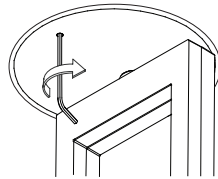

The screw will tighten on the edge of the installation kit

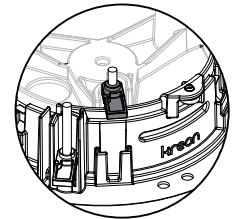
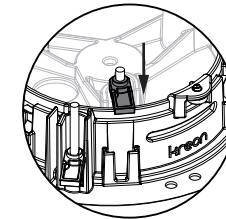
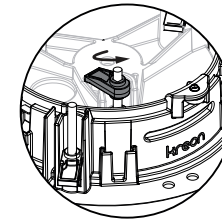

8. installation

The diapason can rotate max. 355°

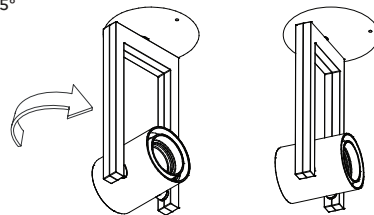

The light can be inclined max. 90°

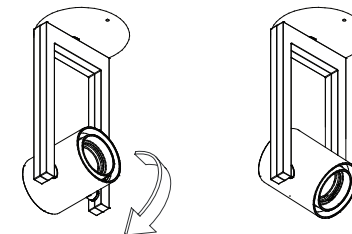

kreon installation manual

pictures



kreon light source information

Fixture reference	LED reference	Energy Efficiency Class	QR-code	EPREL link
KR90661X-9027-XX-XX	KR7000103425	TBD		
KR90661X-9030-XX-XX	KR7000103426	TBD		
KR91661X-9027-XX-XX	KR7000104033	F		https://eprel.ec.europa.eu/qr/1207233
KR91661X-9030-XX-XX	KR7000104034	G		https://eprel.ec.europa.eu/qr/1207509
KR92661X-9027-FL-XX KR92661X-9027-WFL-XX	KR7000103910	F		https://eprel.ec.europa.eu/qr/955131
KR92661X-9027-SP-XX	KR7000103906	G		
KR92661X-9030-FL-XX KR92661X-9030-WFL-XX	KR7000103911	F		https://eprel.ec.europa.eu/qr/1093524
KR92661X-9030-SP-XX	KR7000103907	TBD		
KR92661X-9827-FL-XX KR92661X-9827-WFL-XX	KR7000103298	F		https://eprel.ec.europa.eu/qr/942568
KR92661X-9827-SP-XX	KR7000103290	G		
KR92661X-9830-FL-XX KR92661X-9830-WFL-XX	KR7000103299	F		https://eprel.ec.europa.eu/qr/942567

Fixture reference	LED reference	Energy Efficiency Class	QR-code	EPREL link
KR92661X-9830-SP-XX	KR7000103291	G	