

kreon installation manual

technics & dimensions

In-Line and In-Dolma : Prologe 80 Single, Double , Triple

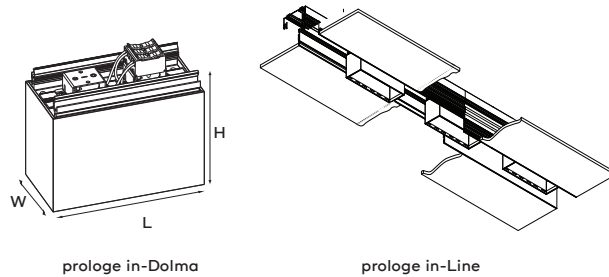

Name	Reference	L x W x H
Prologe 80 in Line / in dolma Single	kr96511x / kr96513x / kr96816x / kr96512x - xxxx	75 x 75 x 175
Prologe 80 in Line / in dolma Double	kr96521x / kr96523x / kr96522x - xxxx	150 x 75 x 175

1. light source information in case of LED

light source containing product

The light source contained in this luminaire shall only be replaced by the manufacturer or his service agent or a similar qualified person.

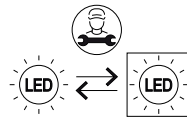

Energy Efficiency Class and EPREL-information for each specific LED/fixture can be found on the last page of this manual

2. installation

electrical diagram

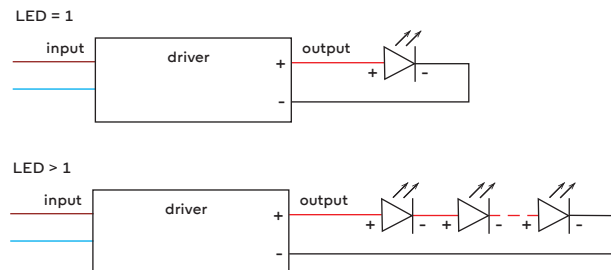

electrical diagram TW

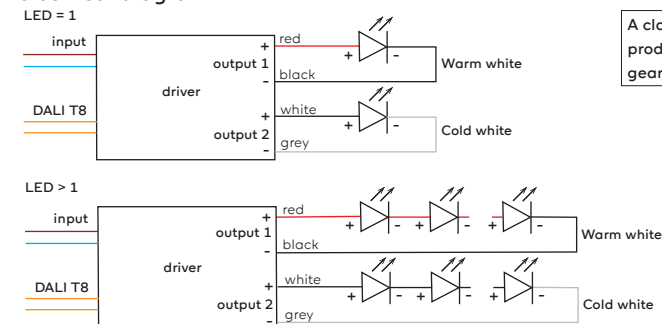

A class III-product or a string of these products in series, can only be used with a gear where $U_{out} \leq 120VDC$!

kreon installation manual

3. cut-out

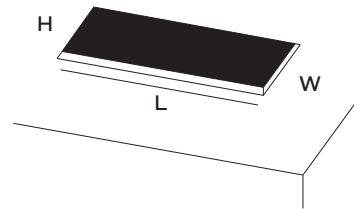

provide correct cut out in plasterboard

Please make sure that
mains voltage is disconnected
before proceeding!

Name

Custom length in-Line Profile

Custom length in-Dolma Profile

Reference

L x W x H

(L+10mm) x 105 x 245

(L+10mm) x 105 x 190

Plasterkit Prologe 80 in-Line Single

kr765114

102 x 105 x 245

Plasterkit Prologe 80 in-Line Double / Single Direct.

kr765214

177 x 105 x 245

Plasterkit Prologe 80 in-Line Triple / Double Direct.

kr765314

252 x 105 x 245

Plasterkit Prologe 80 in-Line

kr765814

627 x 105 x 245

4. installation

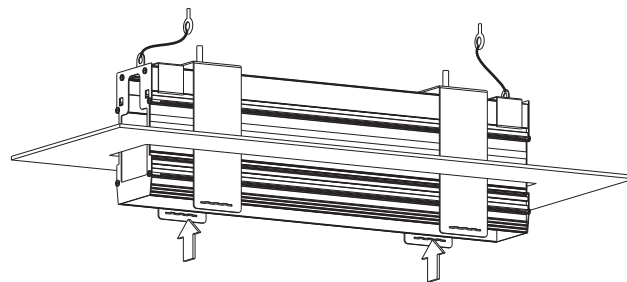

place profile into cutout and connect safety bracket

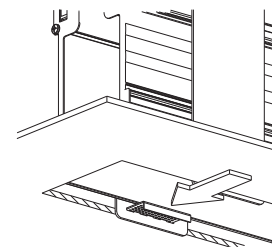

slide perforated brackets into gap

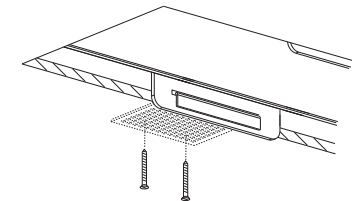

and fix with plasterboard screws

5. installation

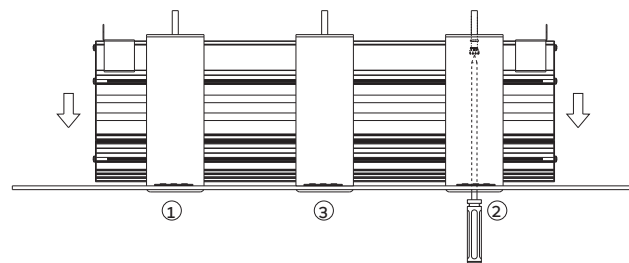

lower profile by turning adjusting screws in the correct order

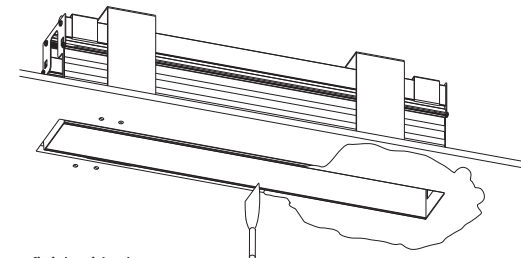

finish with plaster
kreon recommends polyester filler 2K

kreon installation manual

6. installation

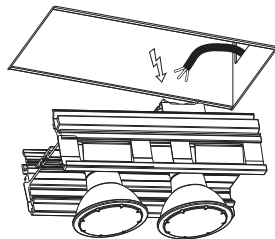

apply correct voltage
and install lamps

* only use single core cables

Name	Reference	Voltage ⚡
Prologe 80 Single	kr96511x / kr96513x / kr96516x / kr96512x - xxxx	230 V
Prologe 80 Double	kr96521x / kr96523x / kr96522x - xxxx	230 V

7. installation

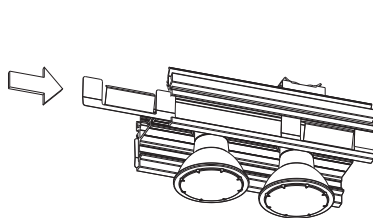

slide springs in chassis

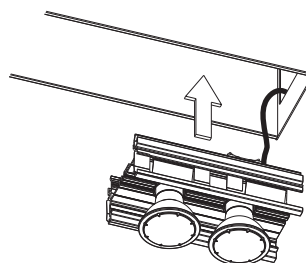

click chassis in profile

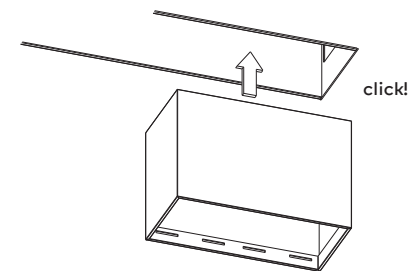
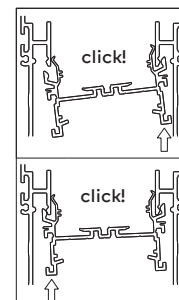

click the housing in the chassis

8. accesories

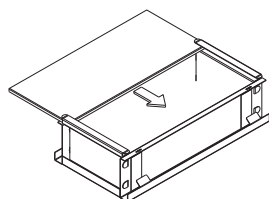

① slide the glass in the louvre.
optional : frosted glass
except for q-par 16 applications

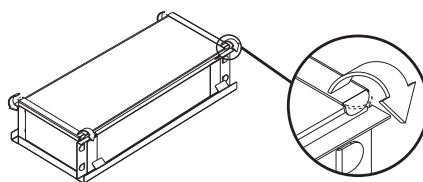

② fold lips around glass

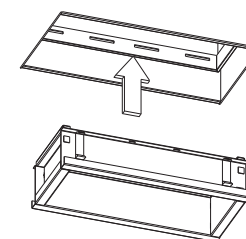



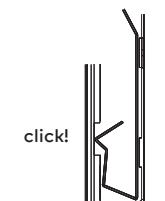





③ insert louvre in housing



④ push louvre in until springs click

kreon light source information

Fixture reference	LED reference	Energy Efficiency Class	QR-code	EPREL link
KR96512X-8327-XX KR96522X-8327-XX	KR7000102787	E		https://eprel.ec.europa.eu/qr/1093490
KR96512X-8330-XX KR96522X-8330-XX	KR7000103036	E		https://eprel.ec.europa.eu/qr/1093489
KR96512X-8340-XX KR96522X-8340-XX	KR7000103030	E		https://eprel.ec.europa.eu/qr/1093487
KR96512X-9027-XX KR96522X-9027-XX	KR7000103886	F		https://eprel.ec.europa.eu/qr/1093518
KR96512X-9030-XX KR96522X-9030-XX	KR7000103887	F		https://eprel.ec.europa.eu/qr/1093517
KR96512X-9040-XX KR96522X-9040-XX	KR7000103889	F		https://eprel.ec.europa.eu/qr/1093515
KR96512X-9827-XX KR96522X-9827-XX	KR7000102912	F		https://eprel.ec.europa.eu/qr/942525
KR96512X-9830-XX KR96522X-9830-XX	KR7000103021	F		https://eprel.ec.europa.eu/qr/942524
KR96512X-9840-XX KR96522X-9840-XX	KR7000103022	F		https://eprel.ec.europa.eu/qr/942522

