

# kreon installation manual

## caution

- the fixture is IP67 rated
- the fixture is water- and dust tight
- water should be able to flow off the product once installed
- client should under no circumstances open the fixture themselves, in case of a problem, the fixture needs to be sent back to Kreon

## technics & dimensions

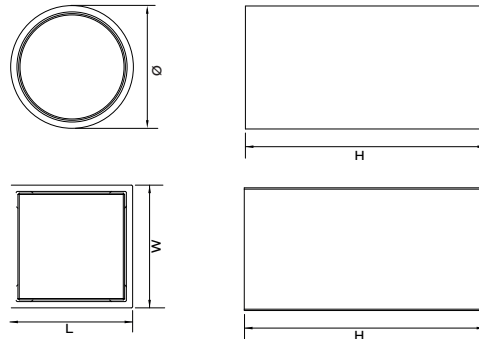

name	reference	LxWxH/ØxH	current	power
up 40 surface mounted circular	KR95291x-90xx-xx	46x90	700mA	2W
up 40 surface mounted circular glare baffle	KR95291x-90xx-xb	46x90	700mA	2W
up 40 surface mounted square	KR95201x-90xx-xx	46x46x90	700mA	2W
up 40 surface mounted square glare baffle	KR95201x-90xx-xb	46x46x90	700mA	2W

Please make sure the main voltage  
is disconnected before proceeding! ⚡

## 1. light source information

### light source containing product

The light source contained in this luminaire shall only be replaced by the manufacturer or his service agent or a similar qualified person.

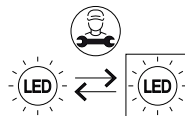

Energy Efficiency Class and EPREL-information  
for each specific LED/fixture can be found on the  
last page of this manual

# kreon installation manual

## 2. installation

### electrical diagram

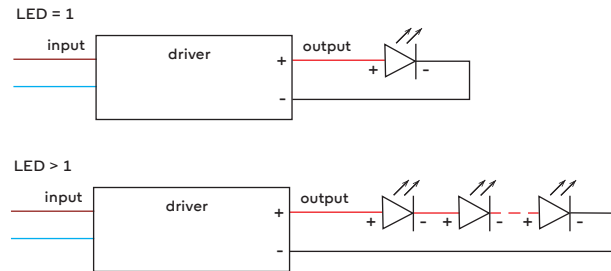

### electrical diagram TW

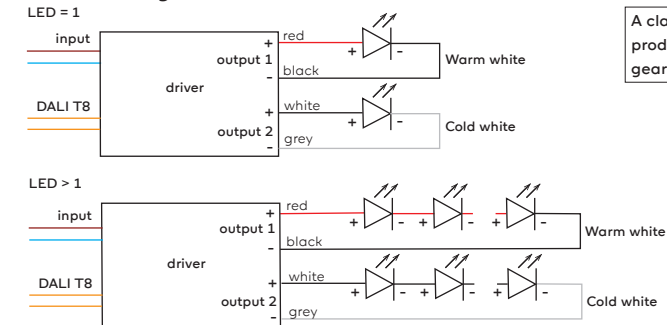

A class III-product or a string of these products in series, can only be used with a gear where  $U_{out} \leq 120VDC$ !

## 3. installation

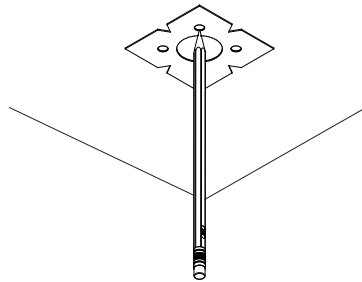

The delivered mold can be used to indicate the fixation holes on the ceiling

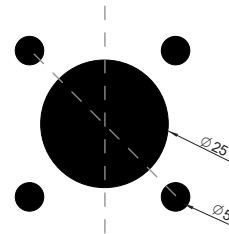

Drill four holes of Ø5mm (depth min. 40mm) for the plugs and drill one hole in the middle of  $\pm \text{Ø}25\text{mm}$  for the cable

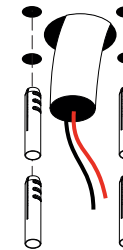

Insert plugs in the holes and pull the cable coming from the driver (700mA) through the hole in the middle

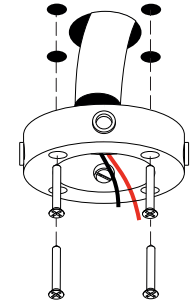

Pull the cable through the center hole and fix installation part to the ceiling with 4 screws

# kreon installation manual

## 4. electric connection

**NOTE:**

mind that the driver cannot be placed next to the fixture (due to its size) and that it has to be positioned at a distance (where it still can be reached in case of a problem)

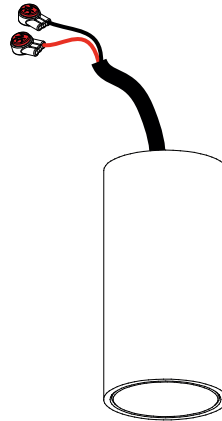

place the wires coming from the up fixture in the delivered connectors (or any desired connector with the correct IP-rate) :

one connector for each wire

wires may not be stripped, push them as far as possible into the connector

don't close the connectors yet

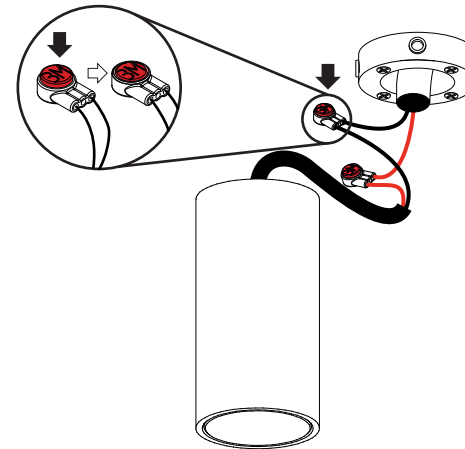

place the wires coming from the driver to the connectors: match red with red and black with black

wires don't need to be stripped, push them as far as possible into the connector

close the connector on that side by applying pressure with a pair of pliers

**NOTE**

Mind the polarity:

red = +

black = -

+ of the connector must match + of the gear

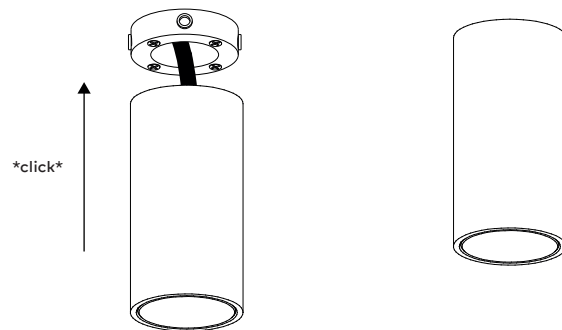

- of the connector must match - of the gear

## 5. installation



Click the up fixture over the installation part on the ceiling. All four springs need to click

# kreon light source information

Fixture reference	LED reference	Energy Efficiency Class	QR-code	EPREL link
KR95291X-9027-XX KR95201X-9027-XX	KR7000103749	E		<a href="https://eprel.ec.europa.eu/qr/1405897">https://eprel.ec.europa.eu/qr/1405897</a>
KR95291X-9030-XX KR95201X-9030-XX	KR7000103752	E		<a href="https://eprel.ec.europa.eu/qr/1406268">https://eprel.ec.europa.eu/qr/1406268</a>