

technics

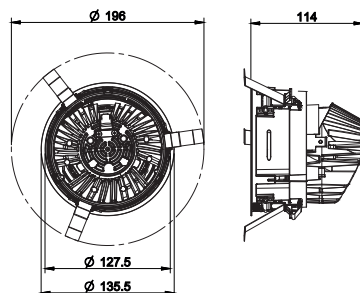

Name	Reference	Drive current
Aplis 120 LED low	KR95793x-xxxx-xxx	700mA

The luminaire must not under any circumstances be covered with heat insulating covers or similar materials.
Cables must not touch the luminaire housing.
The connection cable must be routed so that it does not touch the lamp when the luminaire is tilted.

1 dimensions

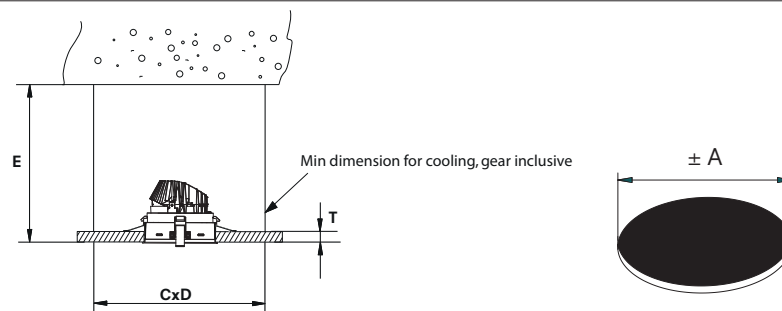

Name	Reference	±A	CxD	E _{min}	T _{min} -T _{max}
Aplis 120 LED low	KR95793x-xxxx-xxx	128	390x390	140	

Plasterboard thickness

9-26

2 cut out

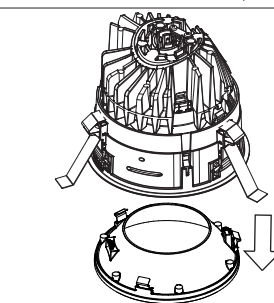

Remove louvre

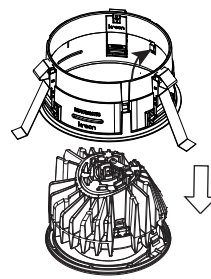

Remove LED module by pressing the springs inwards

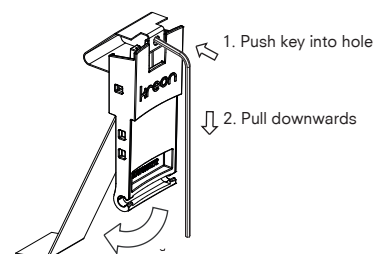

Open spring mechanism (3x) with an allen key.

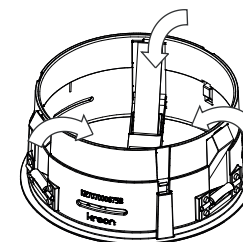

3 installation

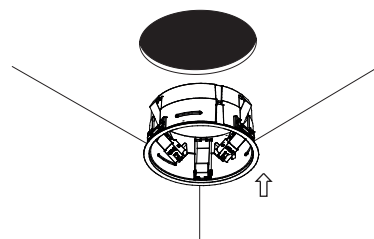

Insert installation box in the hole.

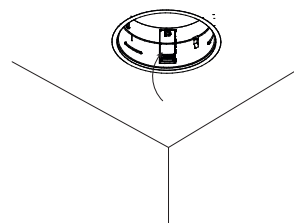

Close spring mechanism (3x) by pushing inwards.

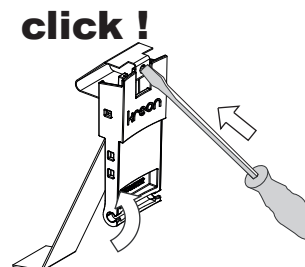

Fix the spring with a tool.

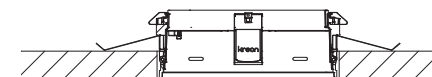

4 installation

kreon nv

Industrieweg Noord 1152
3660 Opglabbeek
Belgium

Tel + 32 89 81 97 80
Fax + 32 89 81 97 90

www.kreon.com
mailbox@kreon.be

revision date: 07/02/2019
KR8079332124

Sheet 1/2

technics

Please make sure that main voltage is disconnected before proceeding! ⚡

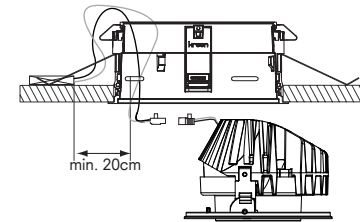
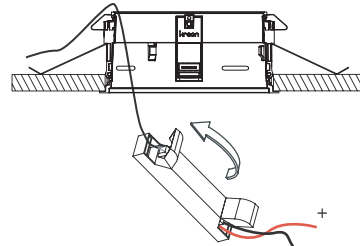

5 installation

install the correct gear with strain relief on the hollow ceiling

important: always check the polarity!!
+ = red wire - = black wire

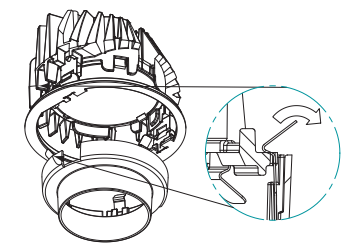
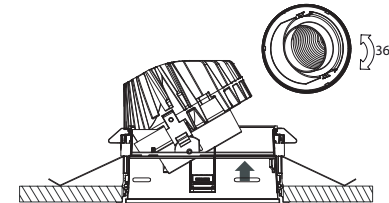
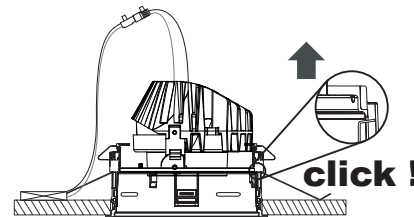
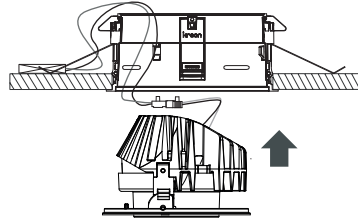

6 installation

Put the assembly in the plasterkit.

push filterholder to rotate and turn inner part manually

Optional:
In case of adding a filter.

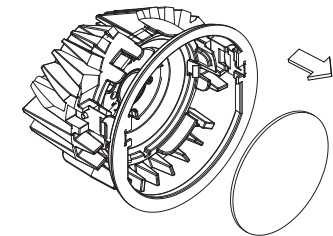
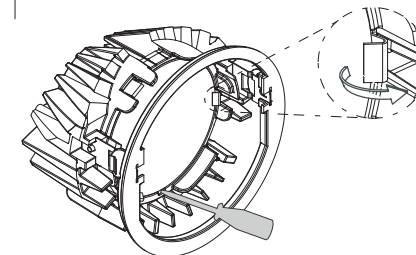
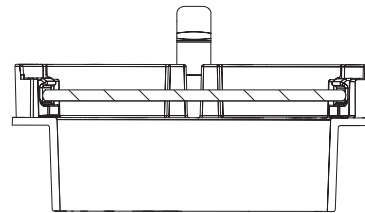
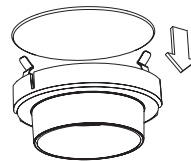

7 installation

Add extra filter to the filterholder.

Maximum capacity= one filter

In case of lens replacement bend the springs to remove the lens.

Remove the lens and add a new lens.

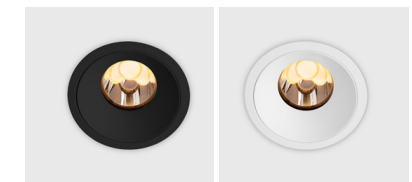
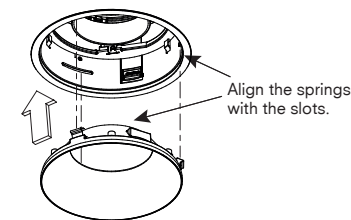
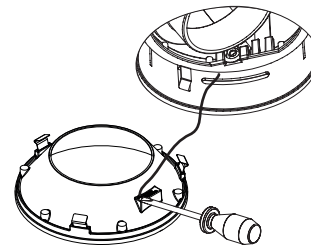
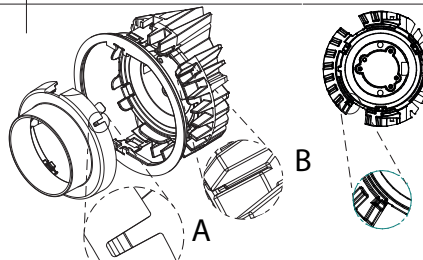

8 installation

When adding the filterholder align A (cutout) with B (rib).

Fix the fall safety cable with added screw to the louvre (in case not done yet).

Insert the louvre in the plasterkit

kreon nv

Industrieweg Noord 1152
3660 Oplabbek
Belgium

Tel + 32 89 81 97 80
Fax + 32 89 81 97 90

www.kreon.com
mailbox@kreon.be

revision date: 07/02/19
KR8079332124

Sheet 2/2