

kreon installation manual

technics & dimensions

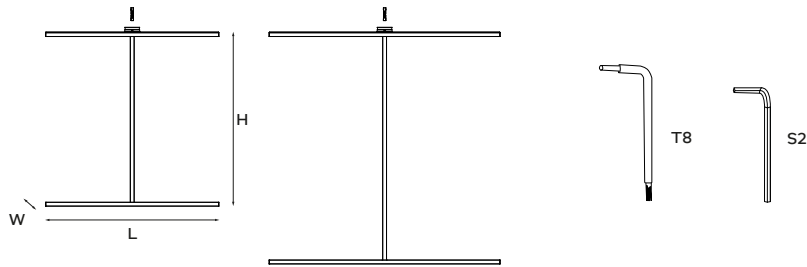

name	reference	current	wattage	B	C	AxB	LxWxH
fuga 900	KR974272-ZZZZ-YY-XX	500mA	9,5W	50	435	102x102	900x20xYY
fuga 1200	KR974372-ZZZZ-YY-XX	500mA	12,7W	50	435	102x102	1200x20xYY

IMPORTANT!

it is advised to only use metal anchor screws (M4, length depending on thickness drywall) instead of standard drywall plugs or universal plugs

Please make sure the main voltage is disconnected before proceeding!



1. installation

BE AWARE: when multiple fuga fixtures are placed next to each other, make sure there is a minimum distance of 100mm between the ceiling profiles (1). you can also use ceiling profiles that are smaller than the LED (2), or install the ceiling profile perpendicular to the LED (3).

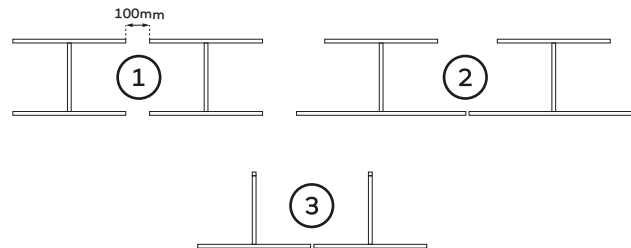

Drill a square hole for the plasterkit and four round holes for the plugs, check the correct measurements for each fuga on the table above, install the plugs before proceeding

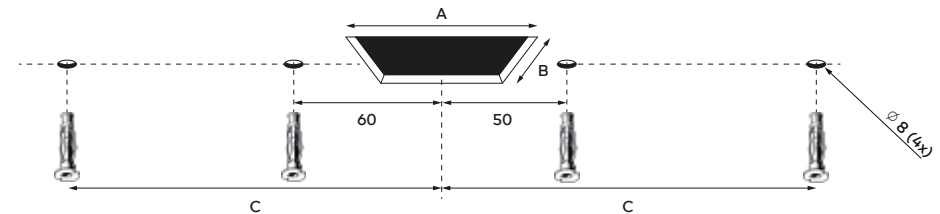

2. installation

To install the down in-line 80 plasterkit see manual KR8170001758, install the correct gear with strain relief on the hollow ceiling

Connect a connector to every cable of the driver

Pull the LED cable through the ceiling profile and mounting plate

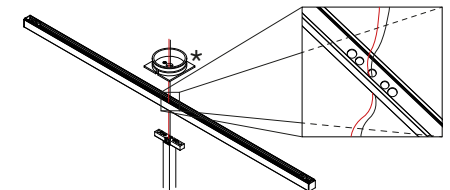
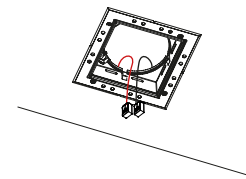
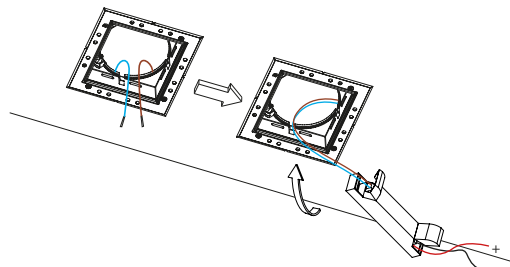

kreon installation manual

3. installation

assemble the parts together with the pre-mounted screws

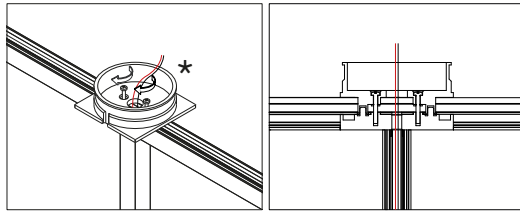

* kreon provides a black and white mounting plate, client can choose which he wants to install

pull the cable for the LED down softly

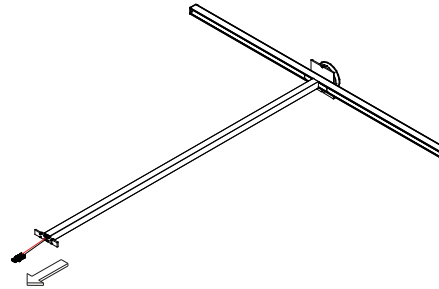

You need to decide the direction of the led element

1. standard set-up, in-line with the ceiling profile, go to step 5

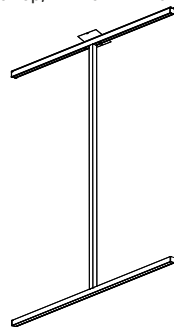

2. in a perpendicular set-up, follow next steps

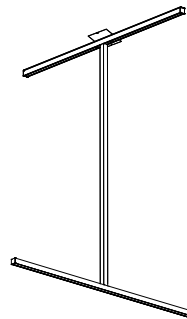

4. perpendicular set-up

Unscrew the 4 screws at the bottom of the coupler and remove them (keep screws for later step)

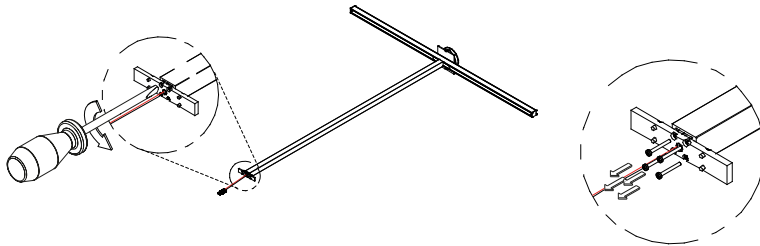

Pull inner part out and turn it 90°

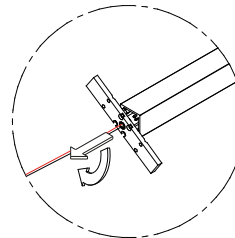

Use the 4 screws and screwdriver to tighten the inner part

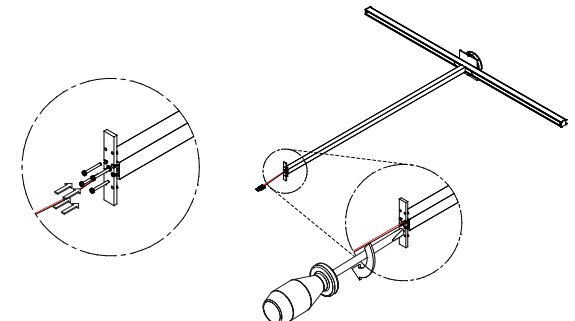

kreon installation manual

5. installation

Remove both end-caps and covers from the LED-element

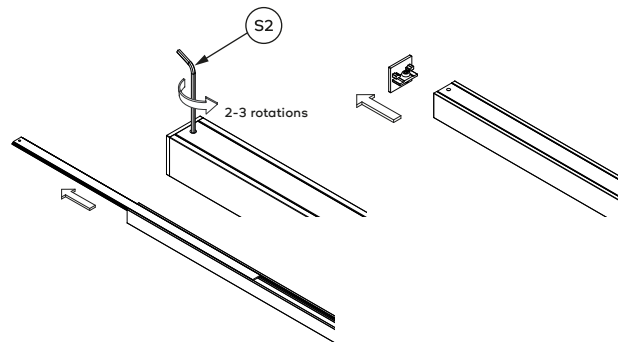

Make sure the connectors are pointed towards each other.

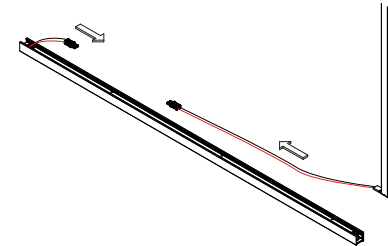

6. installation

Connect the wire to wire connectors, make sure the colors match (red-red, black-black) and that they are placed opposite of each other

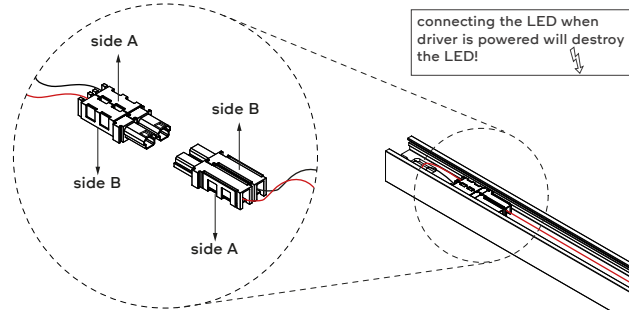

Use the 4 screws provided to attach the LED element to the coupler (if you want the fuga asymmetrical, go to page 4)

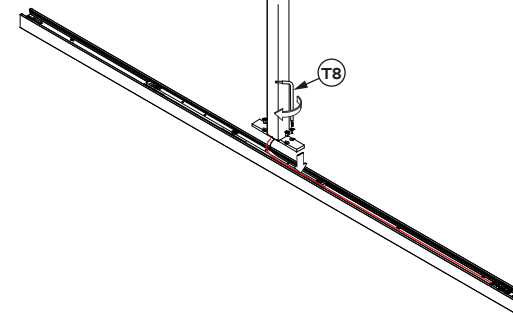

7. installation

Slide the covers back into place, the cable must be tucked under the cover.

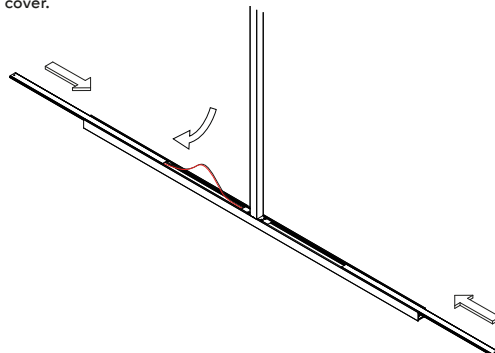

Re-attach the end-caps

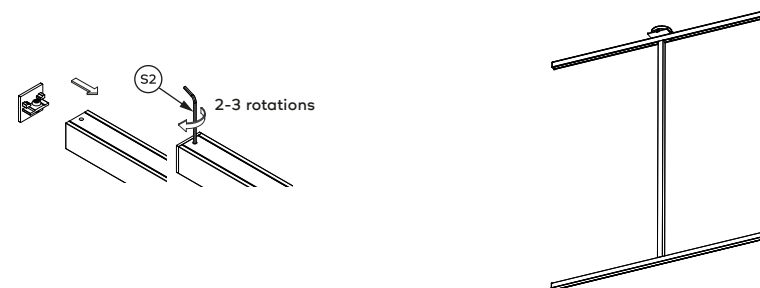

kreon installation manual

8. asymmetrical mode

BE AWARE:
fuga can only be placed asymmetrical if
the ceiling profile is smaller than the LED

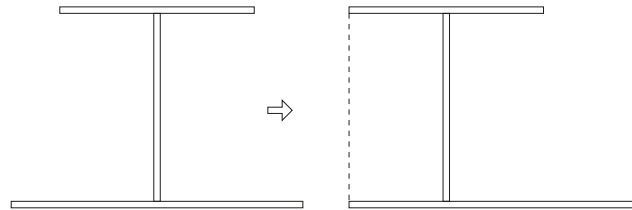

To place the LED asymmetric to the vertical profile, first remove the end-caps

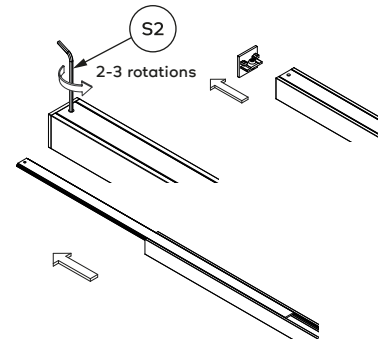

Use the 4 screws provided to attach
the LED element to the coupler

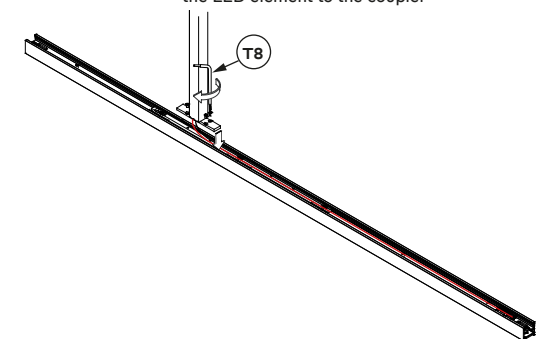

9. asymmetrical mode

Make sure the vertical profile slides away
from the connectors
Slide the asymmetrical covers into place

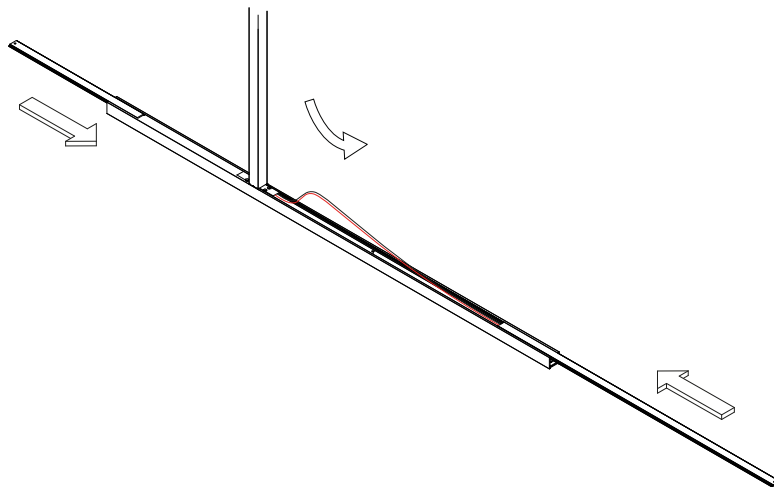

Re-attach the end-caps and fixate the socket set
screw inside the coupler mechanism

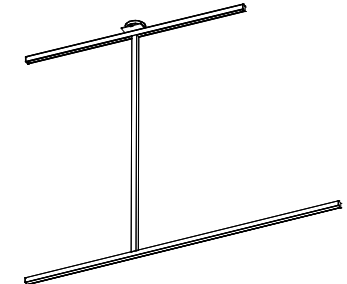
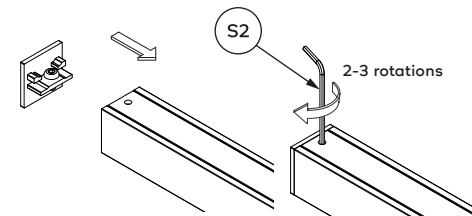

kreon installation manual

10. installation

Remove the end-caps of the ceiling profile by turning the hexagon key 2-3 times, keep the screw inside the end-cap for easier installment later

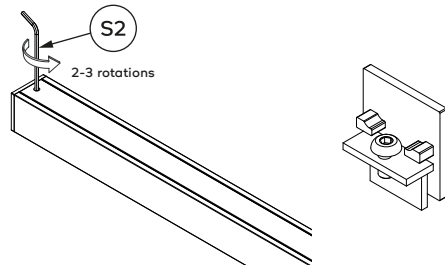

Remove both cover profiles by sliding them out

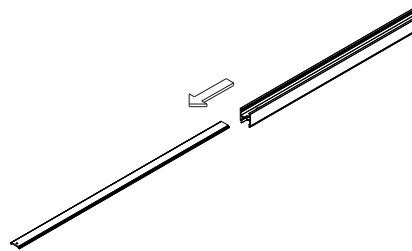

11. installation

Connect the power supply cables to the corresponding color and push the fuga in the plasterkit

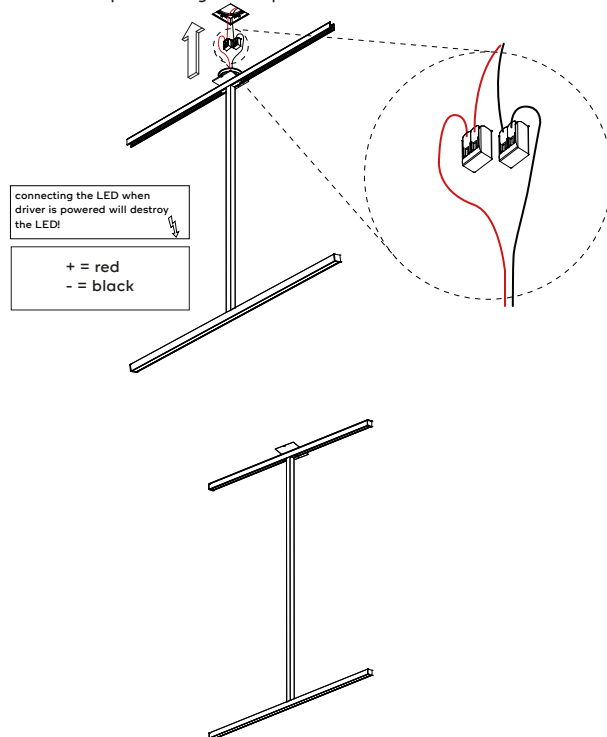

Fixate the ceiling profile with four screws

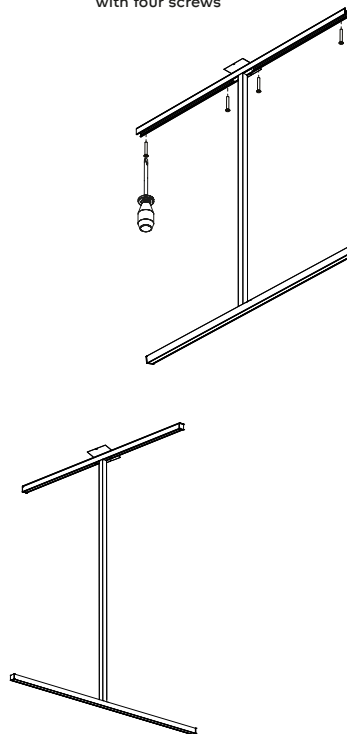

Slide the covers back into place (make sure the hole is on the outside) then put the end-caps back and fixate them with the hexagon key

