

kreon installation manual

technics & dimensions

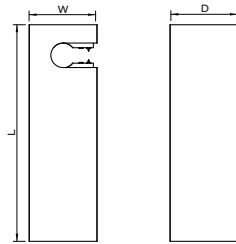

name	reference	voltage	power	LxW	D
Prologe on-kagi wallwasher lvl 2	KR95407X-XXXX-XX-XX	24 V	5,2W	144x45	45
Holon on-kagi wallwasher lvl 2	KR95457X-XXXX-XX-XX	24 V	5,2W	144x45	45

Please make sure the main voltage is disconnected before proceeding!



1. light distribution

The light source contained in this luminaire shall only be replaced by the manufacturer or his service agent or a similar qualified person.

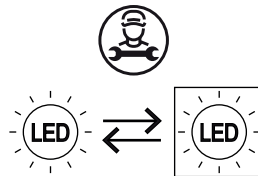

The gear contained in this luminaire shall only be replaced by the manufacturer or his service agent or a similar qualified person

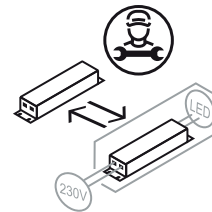

2. preparation

See manual KR8000002364 for installation of the main profile

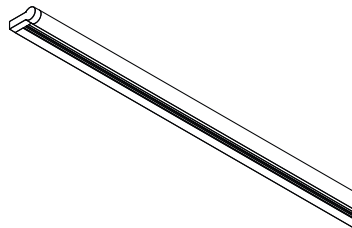

Please note that these fixtures are only suitable for profiles on the second level of your Kagi structure. For fixtures of the first level please see manual KR8000002360. Because the installation of the fixtures is dependant on the direction of the profiles, it is possible to change the output direction of the wallwasher. These steps are marked with an asterix* in the installation manual. If the output direction is already as desired, you can skip these steps.*



✗ NOT OK

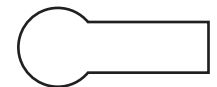

✓ OK

kreon installation manual

3. installation*

Output direction can be changed, see below*

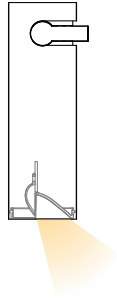

Recommended distance from wall: 60 - 90 cm

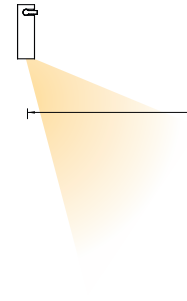

Recommended spacing : 60 - ... cm

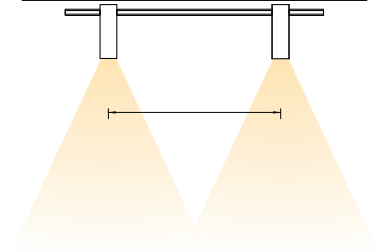

4. installation*

Take the fixture out of the packaging

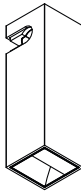

Remove the louvre

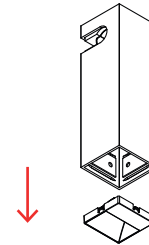

Remove the housing by sliding it down

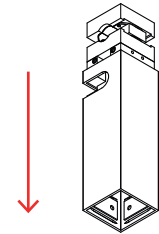

5. installation*

Unscrew the two screws at the bottom

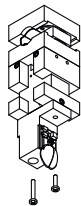

Turn the light engine 180°

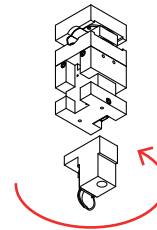

Insert and tighten the screws

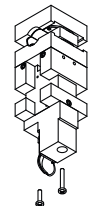

kreon installation manual

6. installation*

Place the housing back over the fixture

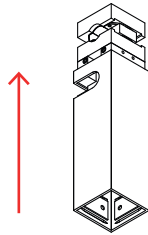

Push the louvre back in place

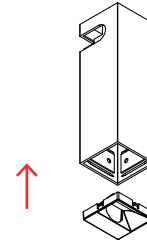

Result

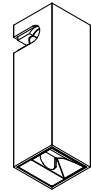

7. installation

Remove the louvre

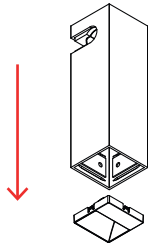

Open the sliders by turning the screw, using the included tool

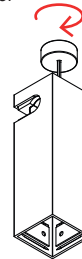

Stop when you feel the blocking mechanism, make sure the sliders are fully open

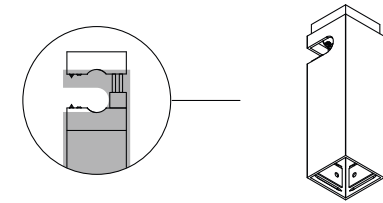

8. installation

Push the fixture slightly deeper into the housing

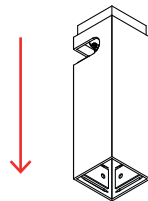

Untill it clicks into it's secondary position

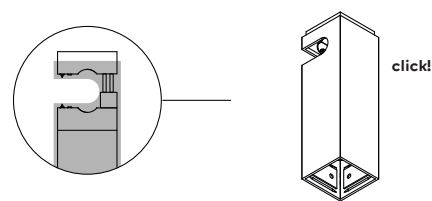

Place the fixture over the profile

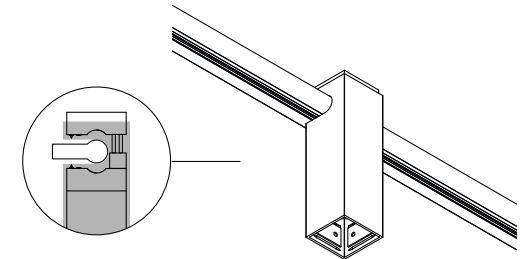

kreon installation manual

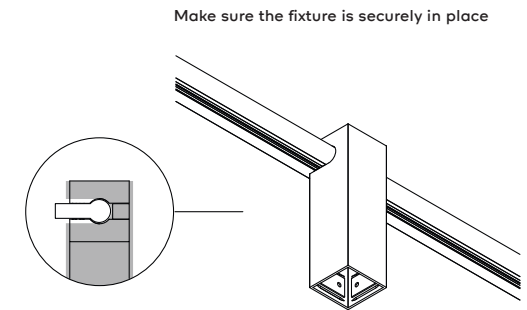
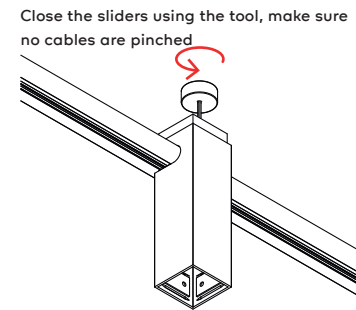
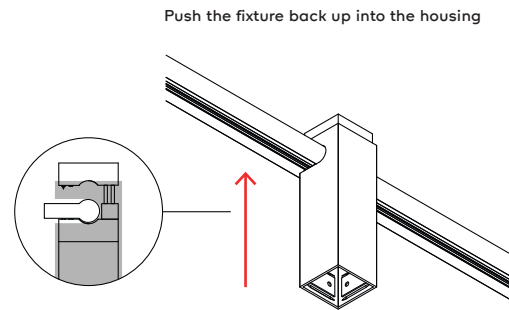

9. installation

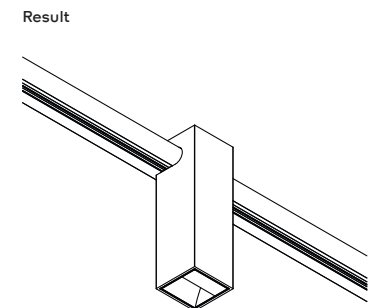
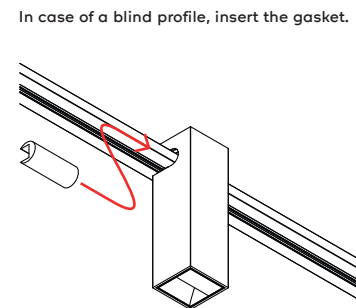
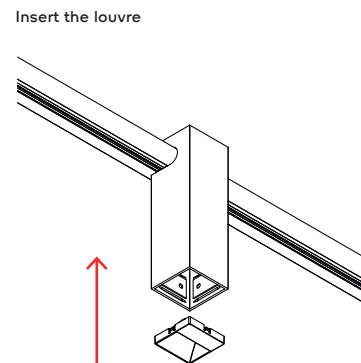

10. installation



kreon light source information

Fixture reference	LED reference	Energy Efficiency Class	QR-code	EPREL link
KR95407X-9027-XX KR95457X-9027-XX	KR7000104320	G		https://eprel.ec.europa.eu/qr/1406175
KR95407X-9030-XX KR95457X-9030-XX	KR7000104321	G		https://eprel.ec.europa.eu/qr/1406210