

# kreon installation manual

## technics & dimensions

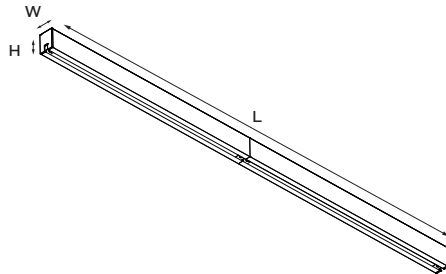

name	reference	voltage Vac	freq	led current	nominal current	wattage	max power	power factor	LxWxH
Nuit profile	NUITxxxxx								Lx42x60mm
nuit module 1x5 SW	KR974190	110-240	50/60Hz	500mA	0,18A	6,9w	26W	0,96	
nuit module 1x5 PD	KR974190	220-240	50/60Hz	500mA	0,14A	6,9w	15W	0,97	
nuit module 1x5 VD	KR974190	110-240	50/60Hz	500mA	0,12A	6,9w	26W	0,96	
nuit module 1x5 DD	KR974190	220-240	50/60Hz	500mA	0,18A	6,9w	30W	0,95	
nuit module 1x5 GE	KR974190	14VDC	-	500mA	-	6,9W	-	-	

### Attention:

- in case of the use of an emergency kit, make sure the emergency is on a separate circuit and having permanently voltage
- in case of gear excluded: 1 driver for max 2 modules

Please make sure the main voltage is disconnected before proceeding! ⚡

## 1. light source information

### light source containing product

The light source contained in this luminaire shall only be replaced by the manufacturer or his service agent or a similar qualified person.

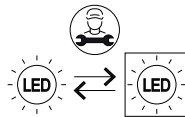

Energy Efficiency Class and EPREL-information for each specific LED/fixture can be found on the last page of this manual

### in case of a gear containing product

the gear contained in this luminaire shall only be replaced by the manufacturer or his service agent or a similar qualified person

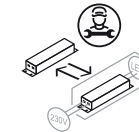

Please make sure the main voltage is disconnected before proceeding! ⚡

## 2. installation in case gear exclusive

### electrical diagram

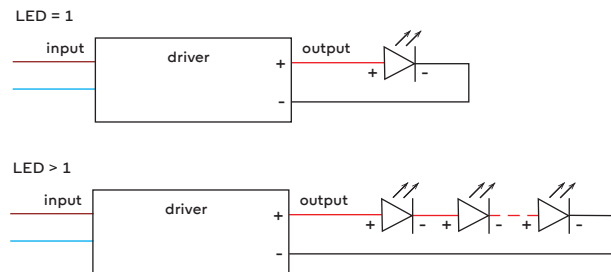

### electrical diagram TW

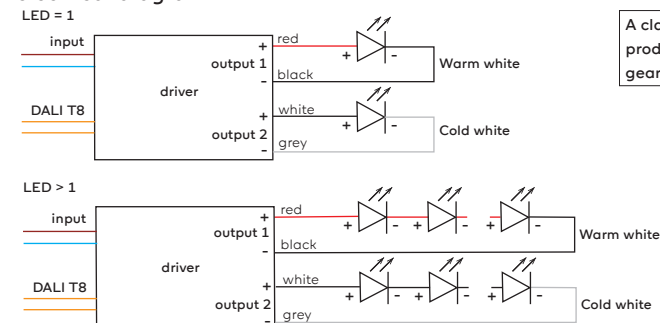

A class III-product or a string of these products in series, can only be used with a gear where  $U_{out} \leq 120VDC$ !

# kreon installation manual

## 3. installation in case of surface mounting

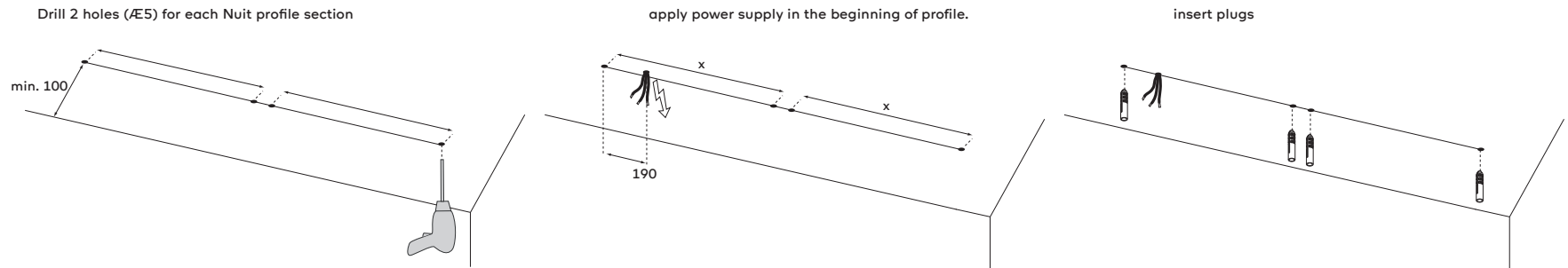

## 4. installation in case of surface mounting

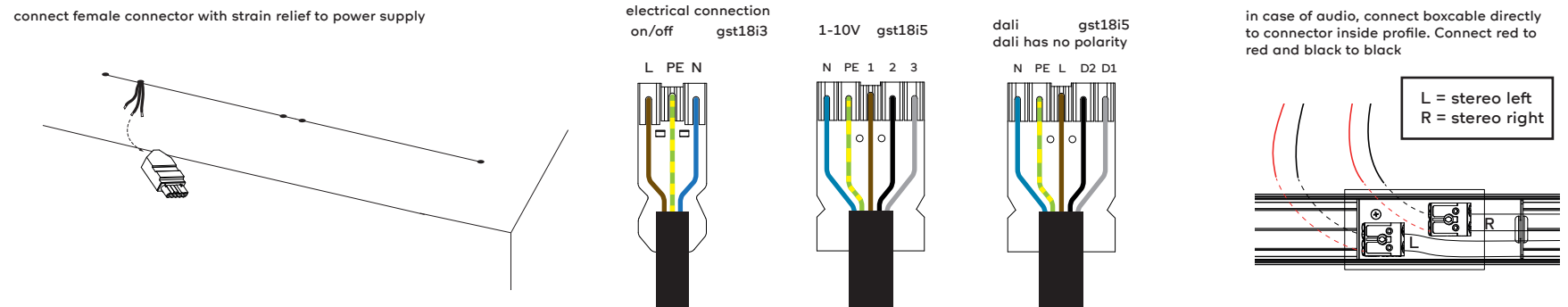

## 5. installation in case of surface mounted

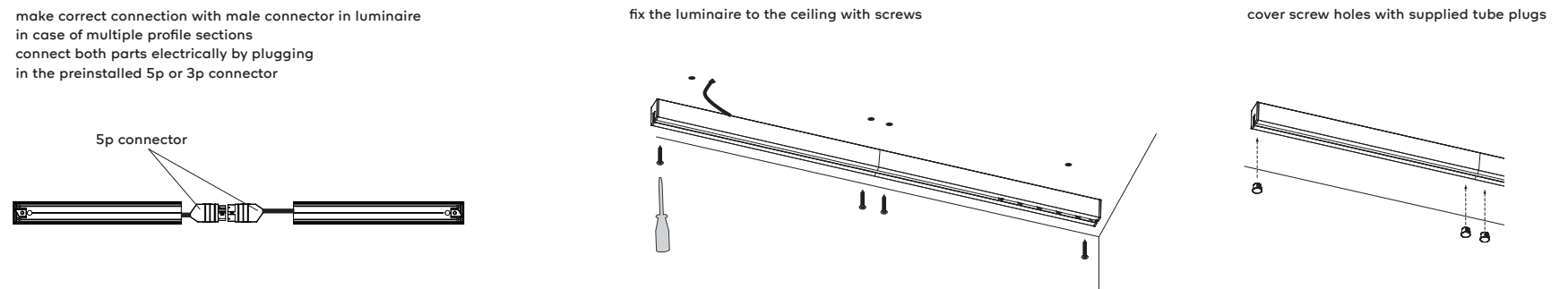

# kreon installation manual

## 6. installation in case of recessed mounted

after installation of the plasterkit or recessed profile, follow the next steps

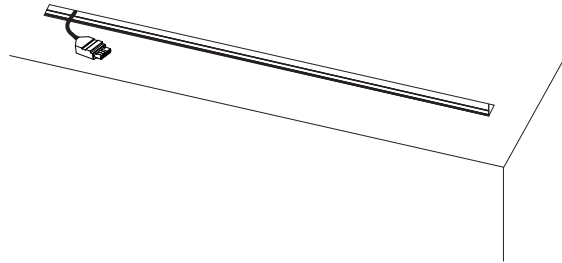

use the supplied parallelogram shaped nuts and screws with countersunk heads

set the nut on top of the screw

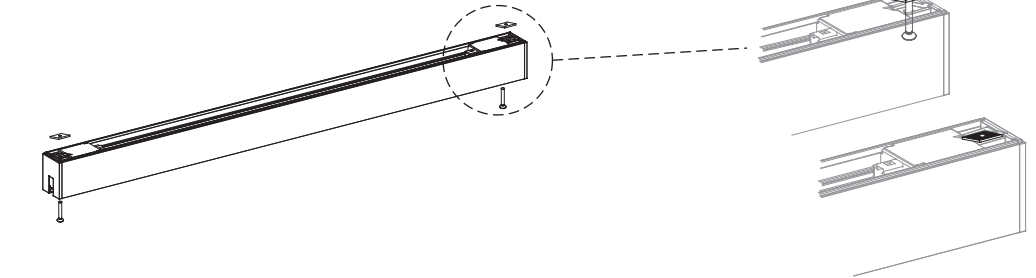

## 7. installation in case of recessed mounted

make correct connection with male connectors in luminaire daisy chaining profiles using only 1 supply cable

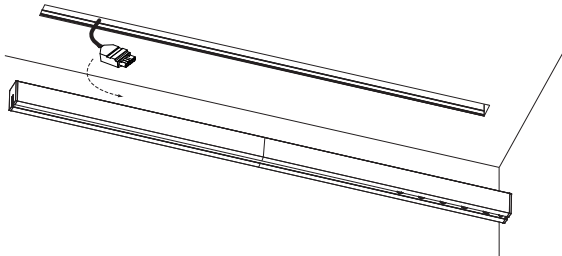

in case of multiple profile sections  
connect both parts electrically by plugging  
in the preinstalled 5p or 3p connector

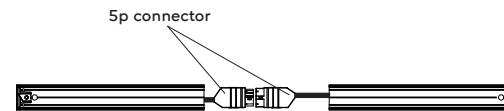

fix the luminaire in the installed recessed profile

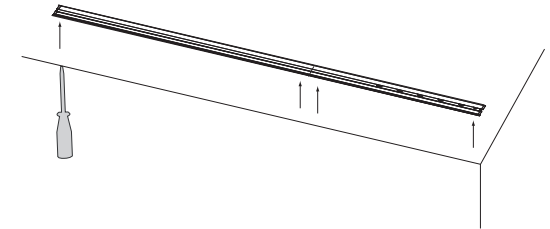

## 8. installation in case of pendant mounted

supply correct power from ceiling  
ATTENTION: switch power off while installing!

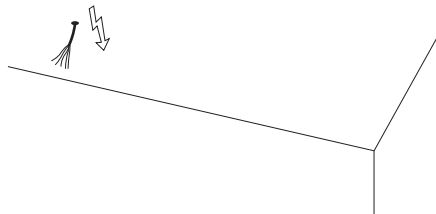

install the top part of the gearbox and wire grip.  
plugs and screws are not supplied, choose correct plugs  
and screws according to the material of the ceiling surface

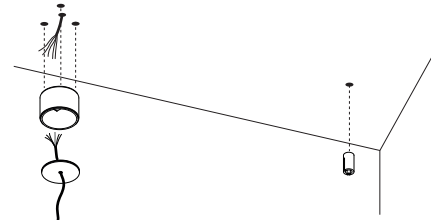

fix steel cables to wire grippers and adjust  
to the correct height  
connect power supply to luminaire

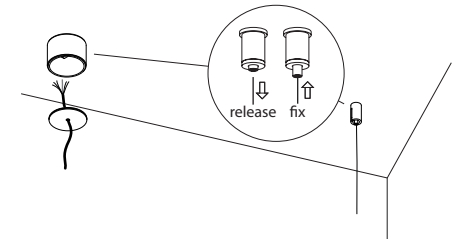

# kreon installation manual

## 9. installation in case of pendant mounted

Mind below cable configuration in order to correctly connect supply, dim and steel cable!

on/off - ph dim

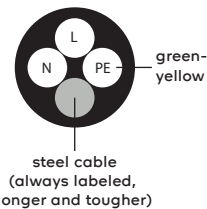

1-10V - dali

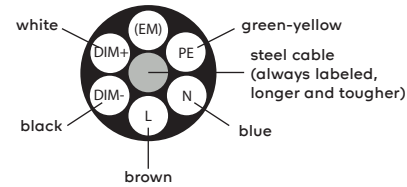

in case of multiple profile sections  
connect both parts electrically by plugging  
in the preinstalled 5p or 3p connector

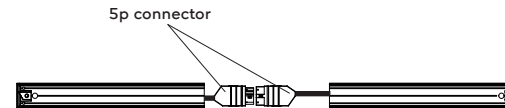

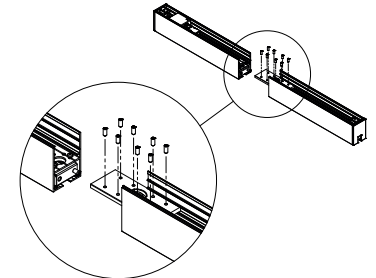

in case of multiple profile sections  
use below connection bracket

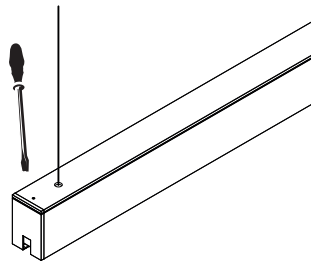

## 10. installation in case of pendant mounted

To remove the cover profile, use m3x20 screw and turn it clockwise .  
The cover will lift itself slightly up, so you can get a grip and pull the cover up and off.



 **IMPORTANT**, in case of Emergency Kit:  
only connect EM battery after the mains  
supply is stable for 24H

# kreon light source information

In order to check the Energy Efficiency Class of the LED in this custom profile, enter the reference on the aluminum label in the profile into the Kreon Eprel search engine.  
This will generate a link to the correct page in the EPREL-database.

<https://www.kreon.com/en/international/eprel>

or

use the QR-code below



example

kreon NUIT  
NUIT213299  
Max. 18W  
230VAC

kreon

home / eprel search

Eprel search

NUIT213299 Submit

Search results

NUIT213299

EPREL - European Product Registry for Energy Labelling

Home > Light sources > 958027

Light sources  
REGULATION (EU) 2019/2015 with regard to energy labelling of light sources

The supplier of this model has not completed the verification process yet. Click here for more

Rena Electronics B.V.  
900D1001.3Z8-2700K

General information	
TYPE OF LIGHT SOURCE	
Lighting technology used	LED
Non-directional or directional	Non-directional
Light source (cap-type for other electric interface)	PCB with connector
Main or non-main	Non-main
Connected light source (CLS)	No
Colour-tunable light source	No
High luminance light source	Yes
Anti-glare shield	No
Dimmable	Yes

ENERGY

35 W/1000h