

Technics

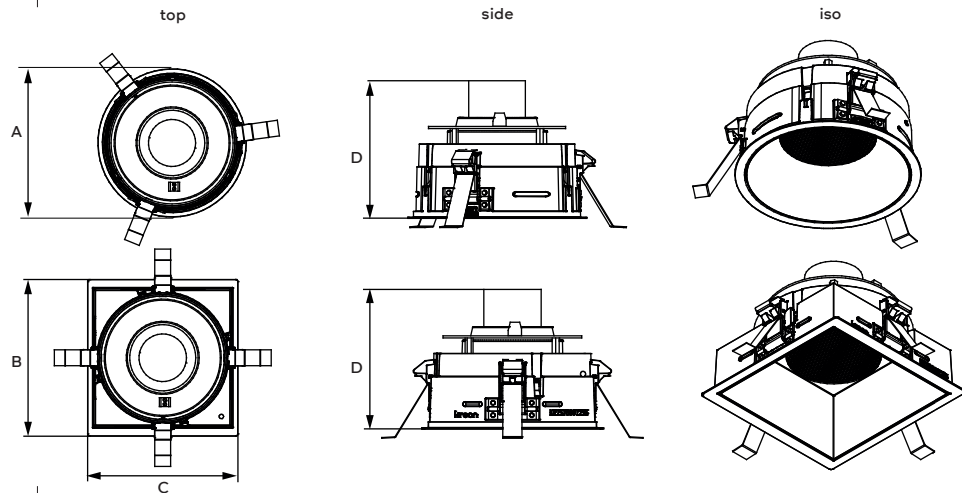

Name	Reference	A	B	C	D
Audio trim 120 Round	KR93799X-RDX	Ø135.5			104.5
Audio trim 120 Square	KR93799X-SQX		141.5	136	104.5

1 Dimensions

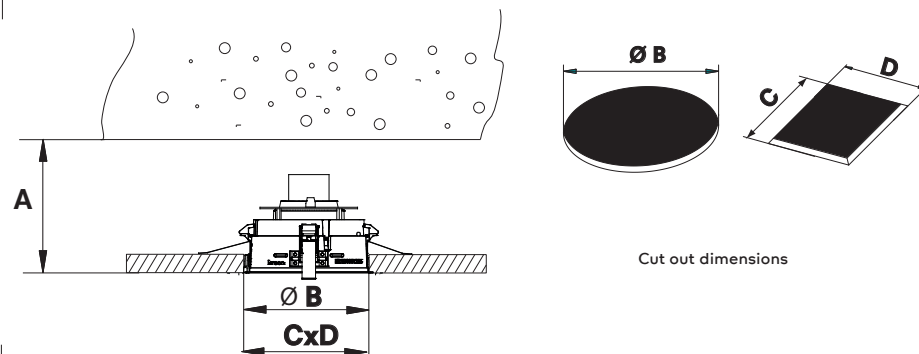

Name	Amin	B	CXD	Tmin-Tmax
Audio trim 120 round	142	Ø128		
Audio trim 120 square	142		128x128	
Plasterboard thickness				9-26

Cut out dimensions

Please make sure the main voltage is disconnected before proceeding!

2 Installation

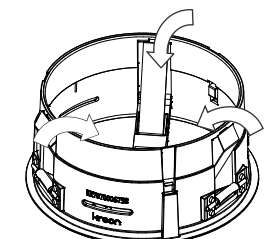
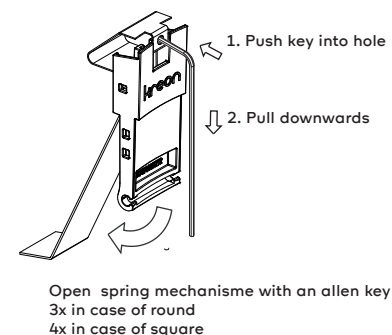
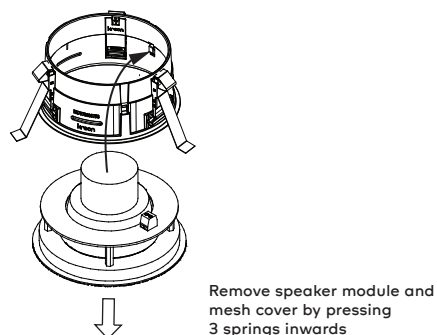
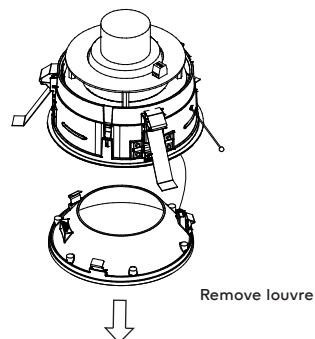

3 Installation

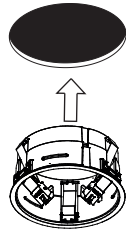

Insert installation box in the hole

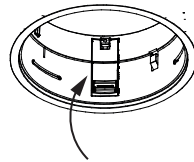

Close spring mechanism by pushing it inwards

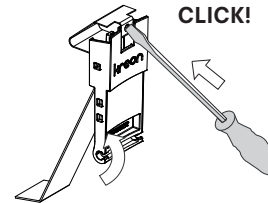

Fix the spring with a tool.
3x in case of round
4x in case of square

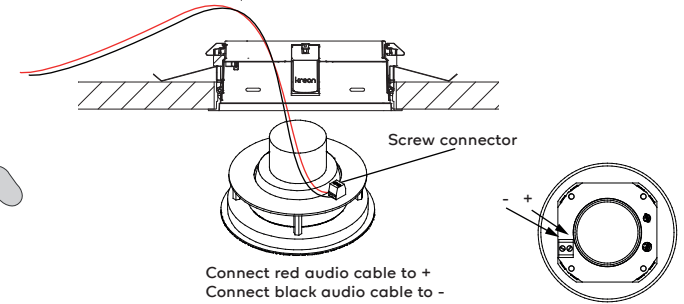

Connect red audio cable to +
Connect black audio cable to -

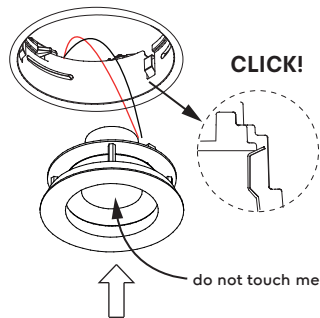

Push in module until 3x CLICK for round
Push in module until 4x CLICK for square

do not touch membrane

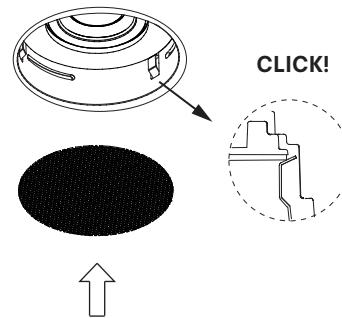

Push in mesh cover until 3x CLICK for round
Push in mesh cover until 4x CLICK for square

Please make sure the 3/4 springs
are keeping module and mesh cover
in place. If needed use flat
screwdriver to pull springs in place.

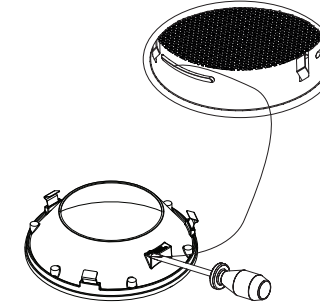

Assemble louvre:
Make sure the fall safety cable is tightly
fixed to the louvre with its screw

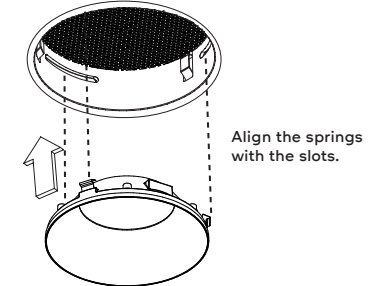

Insert the louvre in the plasterkit

Align the springs
with the slots.

3 Installation

4 pictures

