

technics

Regard single

Please make sure that
main voltage is disconnected
before proceeding!

Reference

cutout L x W x D

plasterkit: L x W x D

installation box: L x W x D

kr90321X

285x145x90

285x145x90

495x240x145

kr90322X

285x145x90

285x145x90

495x240x145

kr90328X

285x145x130

285x145x130

495x240x185

1 cut out

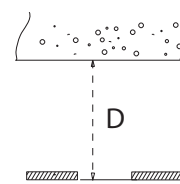
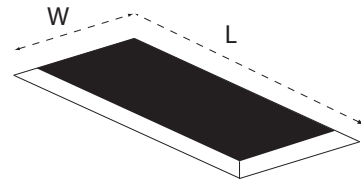

2 cut out/plasterkit

In case of:
cut out/plasterkit

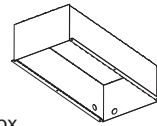
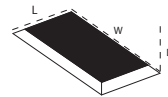

In case of:
installation box

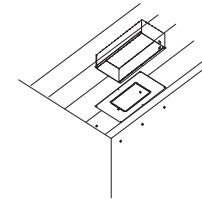
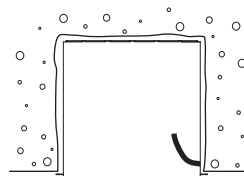

Mount plasterkit

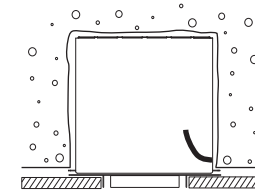

3 installation box

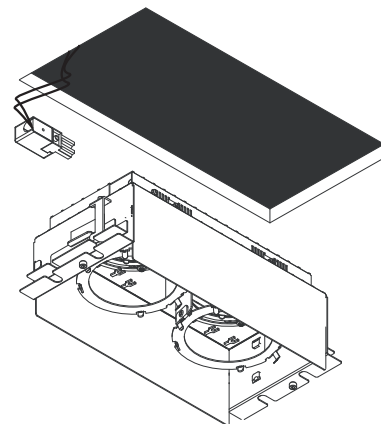
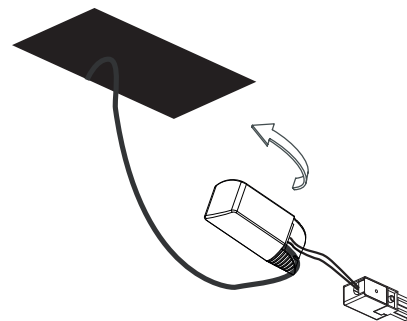

4 installation

connect the mains and the delivered 2P connector
to the gear

connect the 2P female connector (connected to the gear)
to the 2P male connector in the fixture

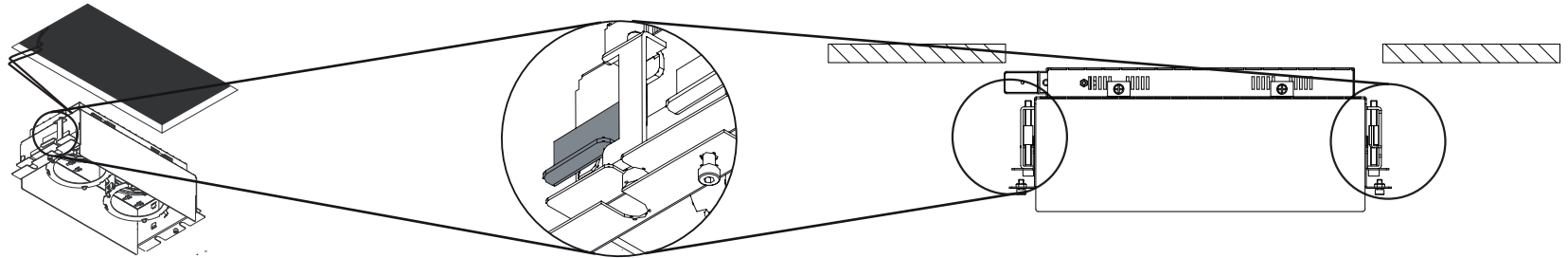

when the fixture is mounted in to the housing,
make sure that the indicated flanges are aligned with the housing
otherwise they might interfere with the installation in the cut-out

5 installation

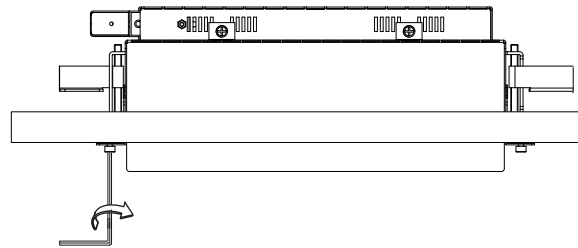
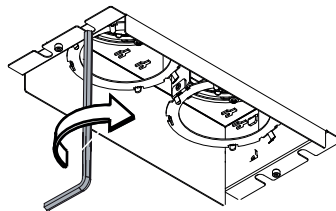

turn to flip the brackets outwards
keep on turning to adjust them against the ceiling
and fix the housing

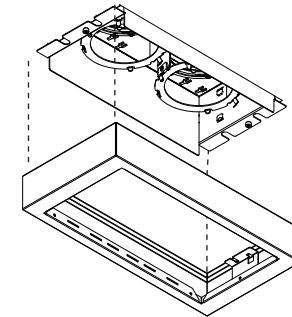

mount the cover

installation

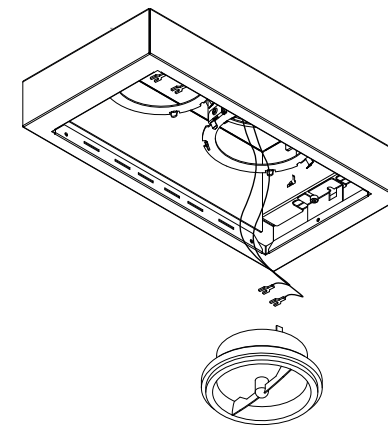
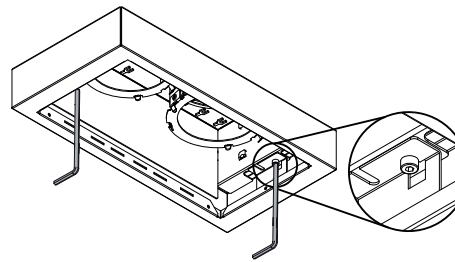
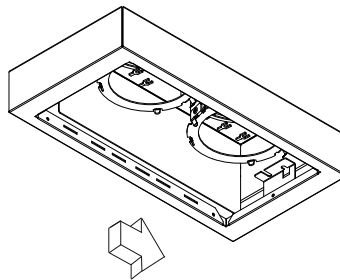

slide the cover underneath the screws that
are already mounted in the housing

fix the screws on both sides with a hex key

mount the lamps by clicking them on the directional set
connect them to the connectors that are delivered

installation

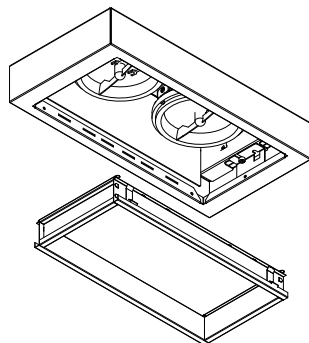

click!



installation

mount the louvre



6 picture