

kreon installation manual

technics & dimensions

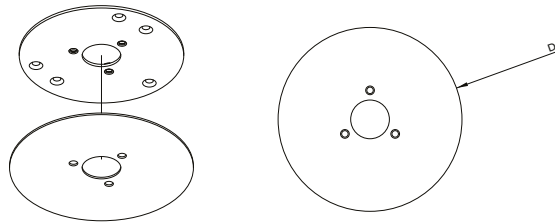

| name | reference | D |
|---------------------------------|-----------|----|
| installation accessory holon 40 | KR76250X | 65 |

Please make sure the main voltage is disconnected before proceeding! ⚡

1. installation

in case of junction box

mount the installation plate with two countersunk screws on the junction box

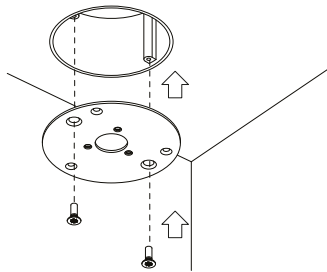

in case of concrete or plasterboard

mark the three installation holes (use the installation plate for easily marking the positions)

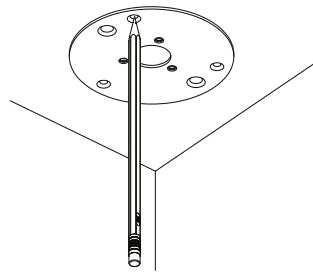

drill three holes for the fixation of the installation plate (holes in the plate have a diameter of D3,5mm)

drill one hole in the middle of min.40mm - max.55mm (*)

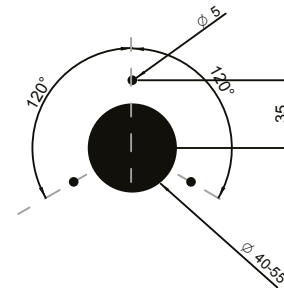

in case the accessory is used for a driver on hollow ceiling situation, make sure the middle hole is big enough to put the driver through (*)

connect the driver to the mains and pre wire it with black/red wire (red =+, black = -) place the driver on the ceiling

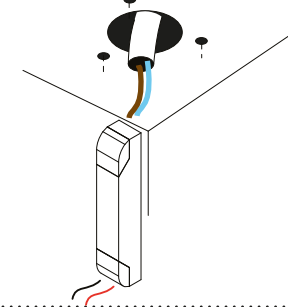

2. installation

pull the wires through the middle hole of the installation plate and fix the plate against the ceiling

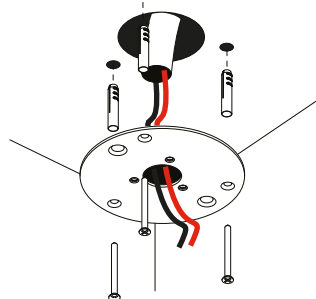

fix the coverplate together with the installation part of the fixture (delivered with the fixture) and three screws against the installation plate

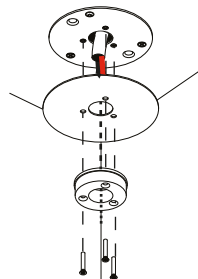

for the installation of the fixture we refer to the installation manuals of the fixtures:

KR8626002024 - holon 40 fixed

KR8622002067 - holon 40 directional surface mounted

