



IMPORTANT SAFETY INSTRUCTIONS - SAVE THESE INSTRUCTIONS

Installation instructions for
Side LED Model number: ku99248x

 **WARNING:** READ AND UNDERSTAND ALL INSTRUCTIONS BEFORE STARTING INSTALLATION. SAVE THESE INSTRUCTIONS FOR FUTURE REFERENCE

 **RISK OF FIRE! - RISK OF SHOCK!**

- INSTRUCTIONS PERTAINING TO A RISK OF FIRE OR INJURY TO PERSONS
- THIS LUMINAIRE MUST BE INSTALLED TO CONFIRM WITH NEC AND ALL LOCAL ELECTRICAL & BUILDING CODES & PRACTICES BY A PERSON FAMILIAR WITH THE CONSTRUCTION AND OPERATION

OF THE PRODUCT AND THE HAZARDS INVOLVED. TO ASSURE FULL COMPLIANCE WITH LOCAL CODES AND REGULATIONS, CONSULT WITH YOUR LOCAL ELECTRICAL INSPECTOR BEFORE INSTALLATION.

- DISCONNECT POWERSUPPLY BEFORE INSTALLING OR SERVICING
- TYPE IC LUMINAIRE
- SUITABLE FOR MOUNTING WITHIN 1.2m OF THE GROUND
- BLINKING LIGHT OF THIS THERMALLY PROTECTED LUMINAIRE MAY INDICATE OVERHEATING
- SUITABLE FOR DAMP LOCATIONS
- SUPPLY CONDUCTORS (POWER WIRE) CONNECTING THE LUMINAIRE MUST BE RATED 90°C
- CONDUCTORS FOR DIMMING MUST

RATED FOR 300V MIN

WARNING - to reduce the risk of FIRE OR INJURY:
- turn off power and allow to cool before replacing LED
- lamp gets HOT quickly!
- to reduce the risk of fire and overheating make sure all connections are tight

This luminaire can only be used with Kreon accessories.

This installation manual might not cover all details or variations. When additional information is required, please contact your local representative, or one of the Kreon offices.

1 notifications

Notice de montage pour
Side LED Modèles: ku99248x

 **ATTENTION:** LIRE ET COMPRENDRE TOUTES LES INSTRUCTIONS AVANT L'INSTALLATION. CONSERVER CES INSTRUCTIONS POUR DE FUTURES REFERENCES

 **RISQUE D'INCENDIE!
RISQUE DE CHOC!**

- INSTRUCTIONS RELATIVES À UN RISQUE D'INCENDIE OU DE BLESSURE
- CE PRODUIT DOIT ETRE INSTALLE SELON LE CODE D'INSTALLATION PERTINENT, PAR UNE PERSONNE QUI CONNAIT BIEN LE PRODUIT ET SON FONCTIONNEMENT AINSI QUE LES RISQUES INHERENTS
- CONSULTER UN ELECTRICIEN QUALIFIÉ POUR VOUS ASSURER QUE LES CONDUCTEURS DE LA DÉRIVATION

SONT ADÉQUATS
- COUPER L'ALIMENTATION AVANT L'ENTRETIEN
- SI L'AMPOULE DE CE LUMINAIRE À PROTECTION THERMIQUE CLIGNOTE, CELA PEUT SIGNIFIER UNE SURCHAUFFE
- LUMINAIRE TYPE IC
- PEUT ETRE INSTALLÉ À MOINS DE 1.2m DU SOL
- CONVIENT AUX EMPLACEMENTS HUMIDES
- LES FILS D'ALIMENTATION DOIVENT CONVENIR POUR 90°C
- CONDUCTEURS POUR LA GRADATION DOIVENT ETRE AU MOINS DE 300V

ALERTE - pour réduire le risque D'INCENDIE OU DE BLESSURE:
- coupez l'alimentation électrique et laissez refroidir avant de remplacer l'ampoule
- la lampe chauffe rapidement!

Le luminaire ne peut être utilisé qu'avec des accessoires de Kreon

Cette notice de montage ne couvre pas tous les détails ou les variations. Pour des informations supplémentaires veuillez contacter votre représentant local ou un des bureaux de Kreon.

1 notifications

technics

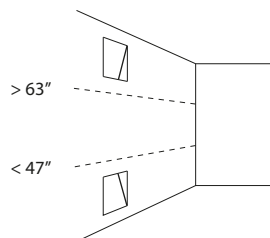

Kreon recommends to install the luminaire as following:
 - install the side higher than 63" from floor if the luminaire is oriented as an uplight.
 - install the side lower than 47" from floor if the luminaire is oriented as a downlight.
 see figure a.

thickness of boardmaterial: 1/3" - 4/5"

2 recommendations

a. recommended orientation

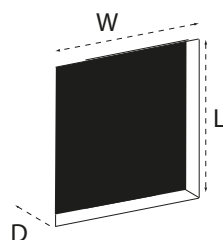

1. cut out wall:
 L 12 3/5" x W 9 1/4" x D 3 9/10"

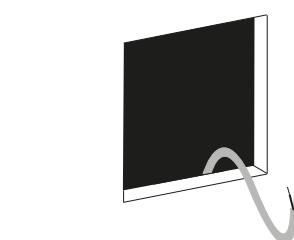

2. get supply wire from wall and follow steps under connection

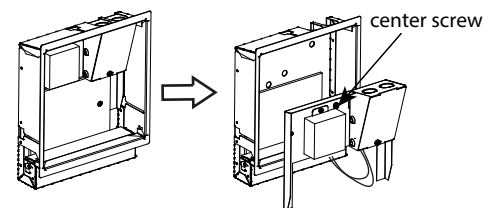

3. take out the reflector and unscrew the center screw, take out the inner plate carefully - do not pull!

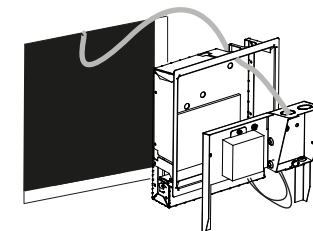

4. lead supply wire in luminaire, remove the knock-out and make connection in j-box

3 installation

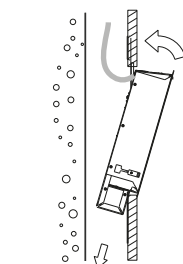

5. insert housing into wall

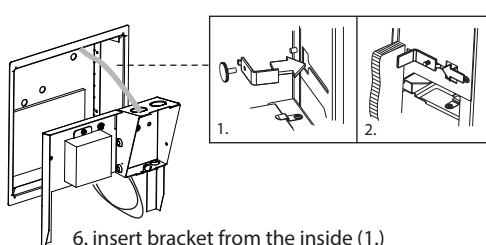

6. insert bracket from the inside (1.) - slide the bracket to the wall (2.) and fix with the thumbscrews

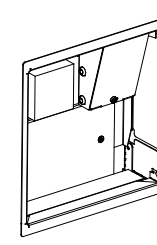

7. replace the innerplate and close the junction-box carefully

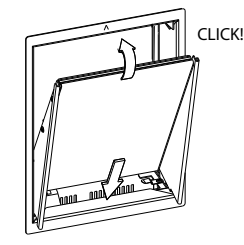

8. insert the reflector, underside first - use plastic gloves

4 installation

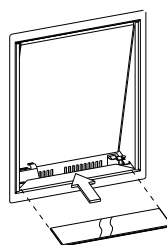

9. insert glass underneath springs

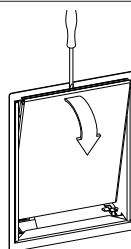

10. different reflectors are possible - use a screwdriver to remove the reflector

5 installation

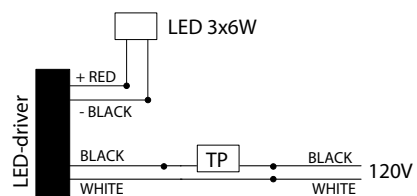

- connect black wire from thermal protector to black supply wire
 - connect white wire from transformer to white supply wire
 - connect green grounding wire in junction box to grounding wire from conduit
 - wire nuts are not included after connection replace cover so all wiring and connections are enclosed
- The driver works on Triac Phase Control Dimmer

6 wiring diagram

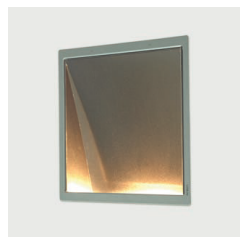

7 pictures