

kreon installation manual

technics & dimensions

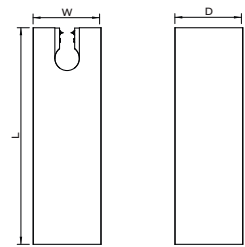

name	reference	voltage	power	LxW	D
Prologe on-kagi fixed lvi 1	KR95402X-XXXX-XX-XX	24 VDC	9,8W	144x45	45
Holon on-kagi fixed lvi 1	KR95452X-XXXX-XX-XX	24 VDC	9,8W	144x45	45

Please make sure the main voltage is disconnected before proceeding!



1. preparation

The light source contained in this luminaire shall only be replaced by the manufacturer or his service agent or a similar qualified person.

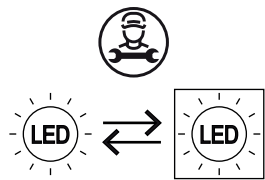

The gear contained in this luminaire shall only be replaced by the manufacturer or his service agent or a similar qualified person

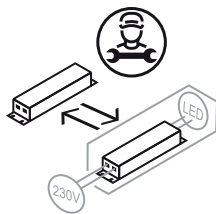

2. installation

See manual KR8000002364 for installation of the main profile

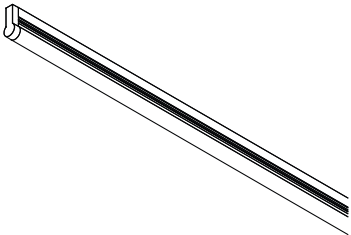

Please note that these fixtures are only suitable for profiles on the first level of your Kagi structure. For fixtures of the second level please see manual KR8000002359.



✓ OK

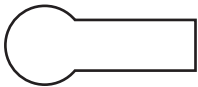

✗ NOT OK

kreon installation manual

3. installation

Remove the housing by sliding it down

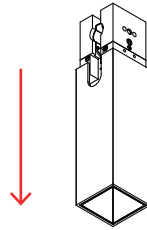

Open the sliders by turning the screw, using the tool from KR754911, or a hex key, until you feel the blocking mechanism

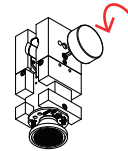

Make sure the sliders are open wide enough to fit over the profile

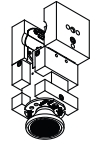

4. installation

Place the fixture over the profile

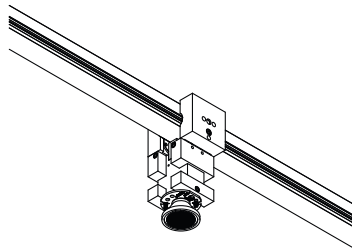

Close the sliders using the tool, make sure no cables are pinched

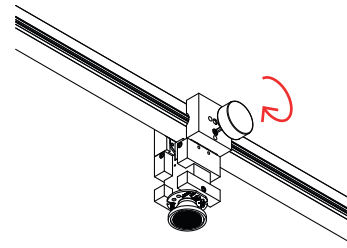

Make sure the fixture is securely in place

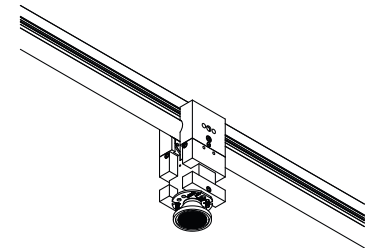

5. installation

Slide the housing back over the fixture

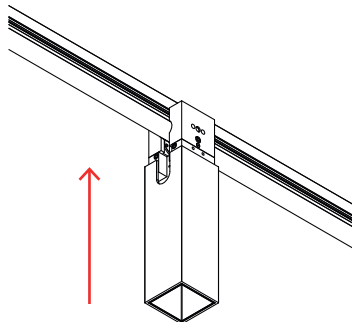

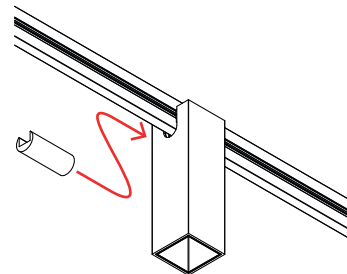

In case of a blind profile, insert the gasket.

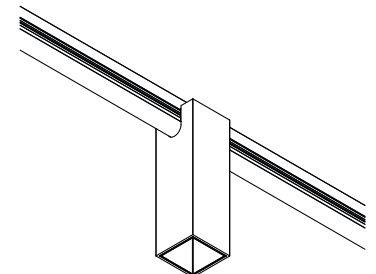

Result



kreon light source information

Fixture reference	LED reference	Energy Efficiency Class	QR-code	EPREL link
KR95402X-9027-XX-XX KR95452X-9027-XX-XX	KR7000104033	F		https://eprel.ec.europa.eu/qr/1207233
KR95402X-9030-XX-XX KR95452X-9030-XX-XX	KR7000104034	G		https://eprel.ec.europa.eu/qr/1207509